

ProSpex Plus XL Bevel Fixed Trimless

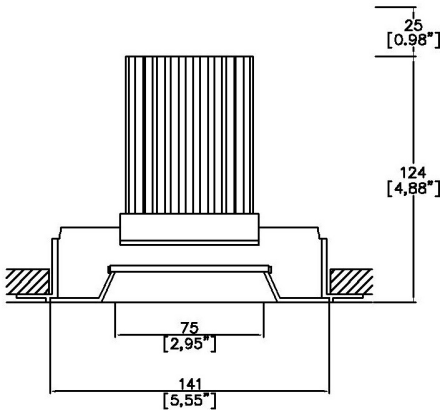

141mm (5.55") overall trimless diameter. Available with standard trim kit or plaster-in kit for flush appearance. Family of matching products also available. Required depth height + 25mm^



LED Source	LED71TW	LED71TW	LED71TW
CCT range 5000K-2000K	@ 3000K	@ 3000K	@ 3000K
Drive Current (max per channel)	1000mA	1000mA	1000mA
Power inc Driver Max	27.5W	27.5W	27.5W
Beam Angle	19°	23°	42°
Delivered Lumens	1486	1416	1383
Delivered Intensisty cd	6173	3735	2241
Efficacy lm/w	54	52	50
Forward Volt (max per channel)	23.4V	23.4V	23.4V
CRI	≥95 CRI	≥95 CRI	≥95 CRI

Project Ref: \_\_\_\_\_

Location Ref: \_\_\_\_\_

Fixture Order Code:

090+XL-13-LED-TL

-

-

-

Fixture

090+XL-13-LED-TL

Plus XL Bevel Fixed Trimless with LED71

Finish

WH

BK

RAL

White

Black

Custom RAL Colour\*

IP Rating

44

IP44

Emergency

E

ED

ES

Maintained 3hr Emergency

Maintained 3hr DALI Self Test

Maintained 3hr Self Test



LED Order Code:

LED71TW

-

5020

-

-

LED

LED71TW

LED70 ONE Tuneable White

CCT

5020

5000K - 2000K

Beam

19

23

42

19°

23°

42°

Protocol

D6

D8

B

DALI Type 6\*\*

DALI Type 8\*\*

Bluetooth\*\*\*



Honeycomb Louvre



Diffusing Lens



Frosted Lens



Heavy Spread Lens



Linear Spread Lens



Warm Tone

Accessories Order Code:

Louvre/Lens

- MN71 Honeycomb Louvre
- MDCC Warm Tone Lens
- MDUV UV Lens
- MDDF Diffusing Lens
- MDFR Frosted Lens
- MDLS Linear Spread Lens
- MDHS Heavy Spread Lens

Technical Details

\*Custom RAL code must be specified. Custom RAL colours can increase prices and lead times

Dimming. Whilst Lucent can offer the majority of its luminaires with various dimming options, it remains the responsibility of the specifier/installer to check and ensure compatibility of any control equipment used. Additional cabling may be required depending on the dimming protocol specified.

\*\*Bluetooth (wireless) is the communication method. The exact dimming protocol must be confirmed to allow the selection of suitable drivers or bluetooth devices.

^ Depth indicated is the minimum recess depth for the luminaire with a remote mounted LED driver. Installing a driver through either the luminaire cut-out or installation kit may require additional recess depth, please refer to the relevant luminaire installation instructions for further details.Data correct at time of publishing

First Fix Requirement. Luminaire comprised of fixture body with ceiling trim and installation kit, which is to be fitted into the ceiling once finished. Ensure correct alignment of the installation kit before final assembly (see luminaire installation instructions for details)

IP Rating. Tested from underside of the ceiling

It is the policy of Lucent Lighting to continually review and improve its products and therefore reserve the right to change any details of product or withdraw specifications without prior notice.

Luminaires designed to comply with EN60598 and all other standards.

This specification sheet superseded all previous versions.

All intellectual property rights pertaining to the product described above and to this document are owned by or licensed to Lucent Lighting Ltd.

We reserve the right to take whatever action is necessary to protect those intellectual property rights.

Please notify Lucent Lighting Ltd of any inaccuracies immediately. E&OE

## Light efficiency:

**54 Lumen/Watt**

## Light quality:

**CRI: 90.2**

## Color temperature:

**3000 K**

**19.9°**

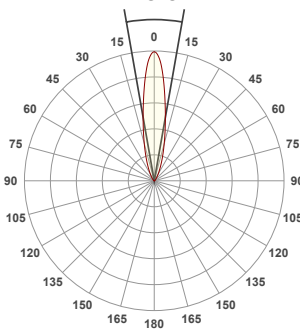

## Product name:

**090+XL-13-LED - LED71W-5020-19 - 3000K**

## Item number:

**Plus XL Bevel Fixed - LED71W-5020-19 @ 3000K**

**Delivered information for above fixture and LED combination.**

**Output: 1486 Lumen Peak intensity: 6173 cd Power consumption: 27.5**

## CRI R values

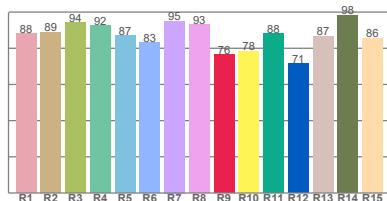

## TM30 C Values

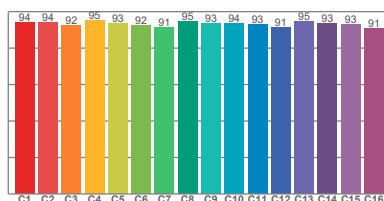

## Color vector graphics

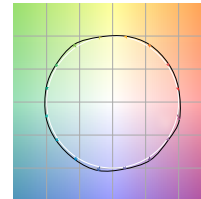

Color temperature	Color rendering index	Red component	Color fidelity	Color gamut	Color quality scale	Color coordinate cie 1931	Color coordinate cie 1931	Color coordinate	Color coordinate	Color deviation from black body
CCT	CRI	CRI R9	TM30 Rf	TM30 Rg	CQS	x	y	u	v	Δuv
3000 K	90.2	76.3	93.4	106.5	93.7	0.437	0.404	0.251	0.348	-0.0155

## Beam details

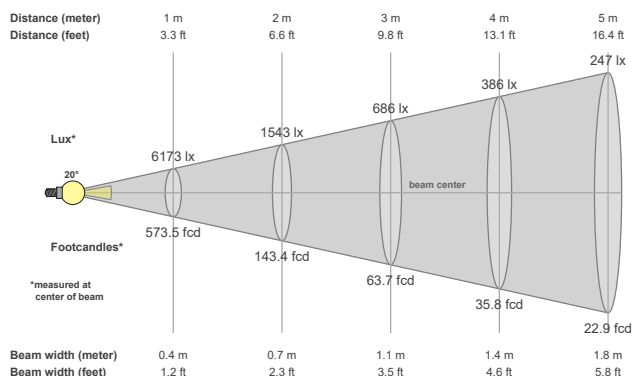

## Beam angles

Beam angle 50%	Field angle 10%	Cutoff angle 2,5%
19.9°	50.7°	79.3°

## Beam intensities

Peak intensity	Int. ratio in 120° cone	Int. ratio in 90° cone
6173 cd	99.5%	95.5%

## Beam intensities from 1-20m

1m	2m	3m	4m	5m	6m	7m	8m	9m	10m	11m	12m	13m	14m	15m	16m	17m	18m	19m	20m
3.3ft	6.6ft	9.8ft	13.1ft	16.4ft	19.7ft	23ft	26.2ft	29.5ft	32.8ft	36.1ft	39.4ft	42.7ft	45.9ft	49.2ft	52.5ft	55.8ft	59.1ft	62.3ft	65.6ft
6173lx	1543lx	686lx	386lx	247lx	171lx	126lx	96lx	76lx	62lx	51lx	43lx	37lx	31lx	27lx	24lx	21lx	19lx	17lx	15lx
573.5fcd	143.4fcd	63.7fcd	35.8fcd	22.9fcd	15.9fcd	11.7fcd	9fcd	7.1fcd	5.7fcd	4.7fcd	4fcd	3.4fcd	2.9fcd	2.5fcd	2.2fcd	2fcd	1.8fcd	1.6fcd	1.4fcd

All the above information for fixtures with LED71TW-5020 modules are tested at 3000K

Factors to adjust lumen output for the following CCTs at 100% output for the colour are as follows:

2000K = 0.75

2700K = 0.93

3500K = 1.07

4000K = 1.11

5000K = 1.17

## Light efficiency:

**51 Lumen/Watt**

## Light quality:

**CRI: 90.0**

## Color temperature:

**3000 K**

30°

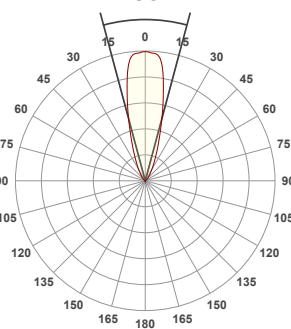

## Product name:

**090+XL-13-LED - LED71W-5020-23 3000K**

## Item number:

**Plus XL Bevel Fixed - LED71W-5020-23 @ 3000K**

**Delivered information for above fixture and LED combination.**

**Output: 1416 Lumen   Peak intensity: 3735 cd   Power consumption: 27.5**

## CRI R values

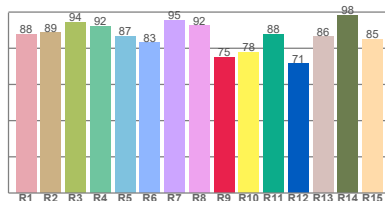

## TM30 C Values

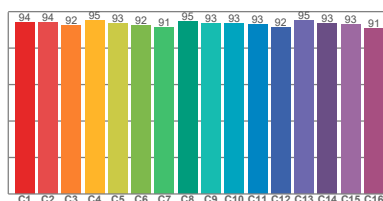

## Color vector graphics

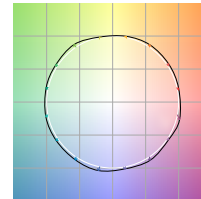

Color temperature	Color rendering Index	Red component	Color fidelity	Color gamut	Color quality scale	Color coordinate cie 1931	Color coordinate cie 1931	Color coordinate	Color coordinate	Color deviation from black body
CCT	CRI	CRI R9	TM30 Rf	TM30 Rg	CQS	x	y	u	v	Δuv
3000 K	90.0	74.9	93.3	106.6	93.8	0.437	0.404	0.251	0.348	-0.0157

## Beam details

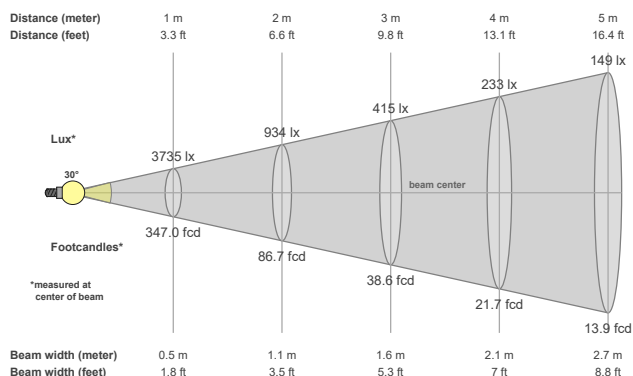

## Beam angles

Beam angle 50%	Field angle 10%	Cutoff angle 2,5%
30°	60.6°	90.2°

## Beam intensities

Peak intensity	Int. ratio in 120° cone	Int. ratio in 90° cone
3735 cd	99.3%	94.9%

## Beam intensities from 1-20m

1m	2m	3m	4m	5m	6m	7m	8m	9m	10m	11m	12m	13m	14m	15m	16m	17m	18m	19m	20m
3.3ft	6.6ft	9.8ft	13.1ft	16.4ft	19.7ft	23ft	26.2ft	29.5ft	32.8ft	36.1ft	39.4ft	42.7ft	45.9ft	49.2ft	52.5ft	55.8ft	59.1ft	62.3ft	65.6ft
3735lx	934lx	415lx	233lx	149lx	104lx	76lx	58lx	46lx	37lx	31lx	26lx	22lx	19lx	17lx	15lx	13lx	12lx	10lx	9lx
347fcd	86.7fcd	38.6fcd	21.7fcd	13.9fcd	9.6fcd	7.1fcd	5.4fcd	4.3fcd	3.5fcd	2.9fcd	2.4fcd	2.1fcd	1.8fcd	1.5fcd	1.4fcd	1.2fcd	1.1fcd	1fcd	0.9fcd

All the above information for fixtures with LED71TW-5020 modules are tested at 3000K

Factors to adjust lumen output for the following CCTs at 100% output for the colour are as follows:

2000K = 0.75

2700K = 0.93

3500K = 1.07

4000K = 1.11

5000K = 1.17

## Light efficiency:

**50 Lumen/Watt**

## Light quality:

**CRI: 90.0**

## Color temperature:

**3000 K**

**42.5°**

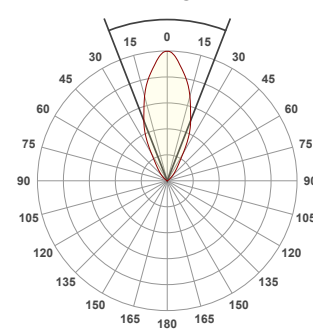

## Product name:

**090+XL-13-LED - LED71W-5020-42 - 3000K**

## Item number:

**Plus XL Bezel Fixed - LED71W-5020-42 - 3000K**

**Delivered information for above fixture and LED combination.**

**Output: 1383 Lumen   Peak intensity: 2241 cd   Power consumption: 27.5**

## CRI R values

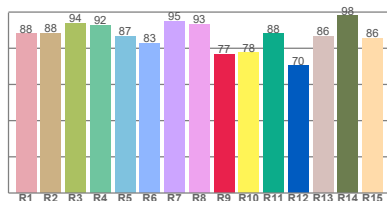

## TM30 C Values

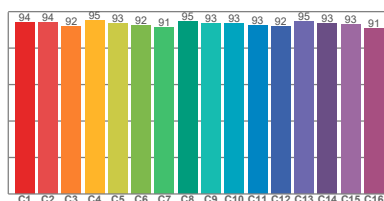

## Color vector graphics

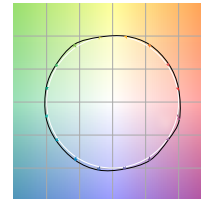

Color temperature	Color rendering Index	Red component	Color fidelity	Color gamut	Color quality scale	Color coordinate cie 1931	Color coordinate cie 1931	Color coordinate	Color coordinate	Color deviation from black body
CCT	CRI	CRI R9	TM30 Rf	TM30 Rg	CQS	x	y	u	v	Δuv
3000 K	90.0	76.5	93.3	106.4	93.6	0.437	0.404	0.251	0.348	-0.0156

## Beam details

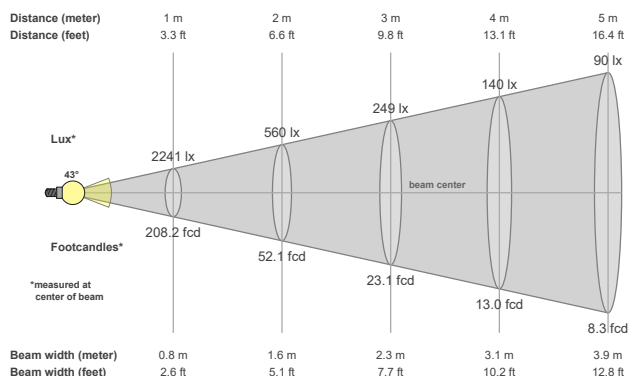

## Beam angles

Beam angle 50%	Field angle 10%	Cutoff angle 2,5%
42.5°	79.7°	105°

## Beam intensities

Peak intensity	Int. ratio in 120° cone	Int. ratio in 90° cone
2241 cd	99.6%	93.7%

## Beam intensities from 1-20m

1m	2m	3m	4m	5m	6m	7m	8m	9m	10m	11m	12m	13m	14m	15m	16m	17m	18m	19m	20m
3.3ft	6.6ft	9.8ft	13.1ft	16.4ft	19.7ft	23ft	26.2ft	29.5ft	32.8ft	36.1ft	39.4ft	42.7ft	45.9ft	49.2ft	52.5ft	55.8ft	59.1ft	62.3ft	65.6ft
2241lx	560lx	249lx	140lx	90lx	62lx	46lx	35lx	28lx	22lx	19lx	16lx	13lx	11lx	10lx	9lx	8lx	7lx	6lx	6lx
208.2fcd	52.1fcd	23.1fcd	13fcd	8.3fcd	5.8fcd	4.2fcd	3.3fcd	2.6fcd	2.1fcd	1.7fcd	1.4fcd	1.2fcd	1.1fcd	0.9fcd	0.8fcd	0.7fcd	0.6fcd	0.6fcd	0.5fcd

All the above information for fixtures with LED71TW-5020 modules are tested at 3000K

Factors to adjust lumen output for the following CCTs at 100% output for the colour are as follows:

2000K = 0.75

2700K = 0.93

3500K = 1.07

4000K = 1.11

5000K = 1.17