

Installation Instructions- EasyFit Plus Mini with Installation kit

For Plus Mini Fixed, Adjustable and Wallwash

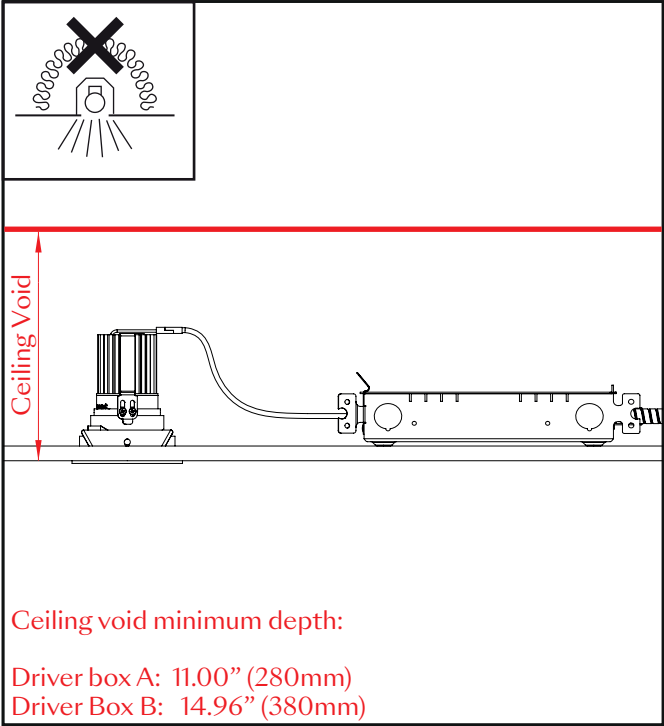

Do not cover any element of the installation with insulation material.

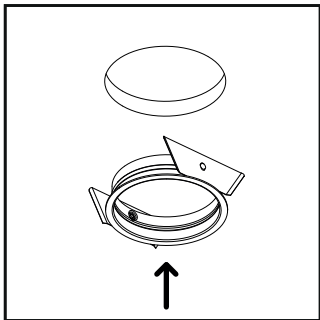
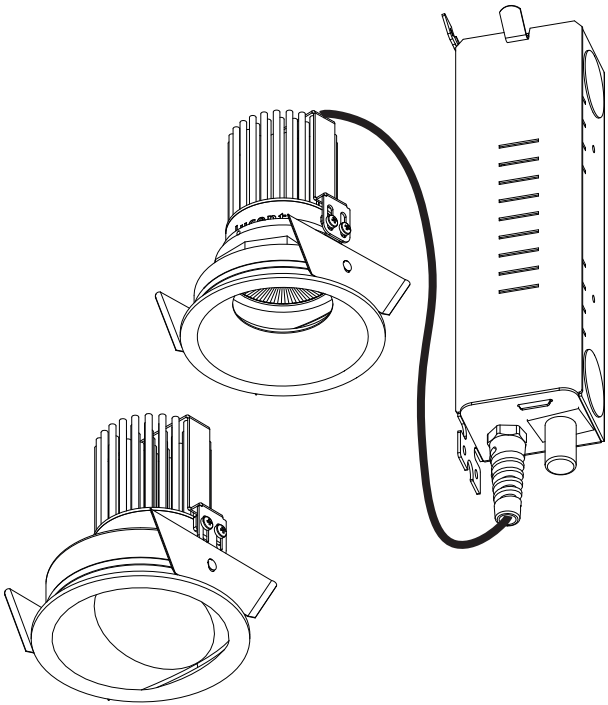

1. Cut out hole in ceiling and insert installation kit.
Cutout size Ø3.23" (Ø82mm)

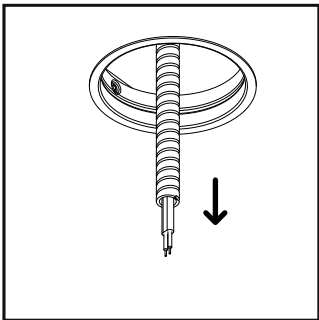

2. Bring through main power connection

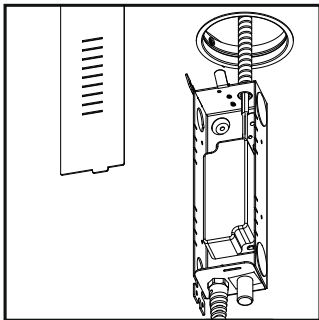

3. Remove Lid on Easyfit box to access driver. Connect driver to mains power.

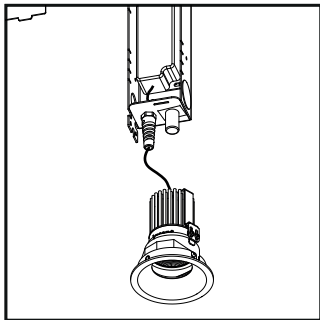

4. Make connection with driver.

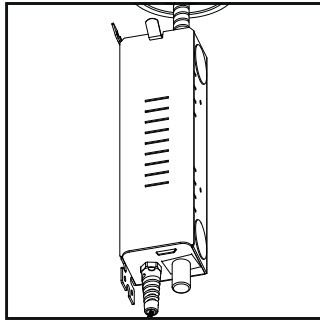

5. Replace lid on Easyfit box.

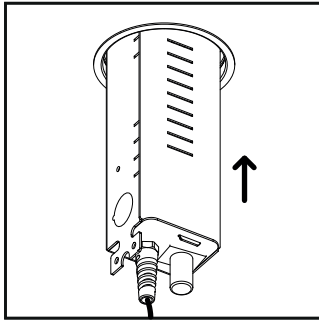

6. Pass Easyfit box through installation kit.

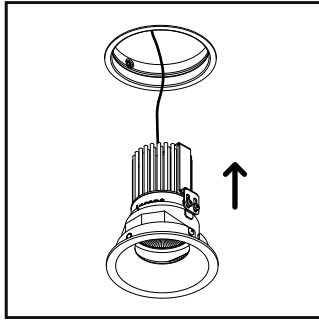

7. Insert fitting into installation kit.

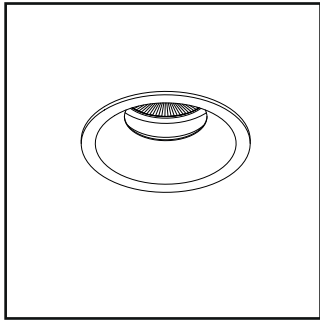

8. Finished installation.