

# ProSpex100 Wallwash

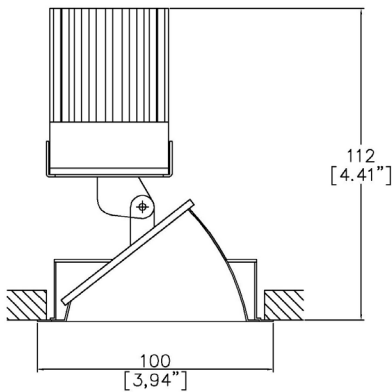

100mm (3.94”) overall diameter. Available with standard trim kit or plaster-in kit for flush appearance. Family of matching products also available. Required depth height + 25mm^



100-LED-WW

LED Source	LED51/2
CCT	3000K
Drive Current	350mA
Power inc Driver	13.6W
Beam Angle	38°
Delivered Lumens	595
Delivered Intensisty cd	745
Efficacy lm/w	44
Forward Volt	33V
CRI	≥90 CRI

Project Ref: \_\_\_\_\_ Location Ref: \_\_\_\_\_

Fixture Order Code:  -  -  -  -

Fixture	100-LED-WW	Reflector100 Wallwash with LED51
Reflector Finish		
PS		Polished Silver
SS		Satin Silver
CG		Champagne Gold
BK		Black
WH		White
Trim Finish		
WH		White
BK		Black
RAL		Custom RAL Colour*
IP Rating	54	IP54
Emergency		
E		Maintained 3hr Emergency
ED		Maintained 3hr DALI Self Test
ES		Maintained 3hr Self Test

LED Order Code:  -  -  -

LED	LED51/2	LED50 ONE GEN2
CCT		
927		90 CRI 2700K
930		90 CRI 3000K
940		90 CRI 4000K
Beam	38	38°
Protocol		
S		Non-Dim
A		Analogue (0-10v)
P		Phase
D		DALI
B		Bluetooth**



Honeycomb Louvre



Warm Tone

Accessories Order Code:

- Louvre/Lens
- LL45 Honeycomb Louvre
  - LLCC Warm Tone Lens
  - LLUV UV Lens

Technical Details

\*Custom RAL code must be specified. Custom RAL colours can increase prices and lead times

Dimming. Whilst Lucent can offer the majority of its luminaires with various dimming options, it remains the responsibility of the specifier/installer to check and ensure compatibility of any control equipment used. Additional cabling may be required depending on the dimming protocol specified.

\*\*Bluetooth (wireless) is the communication method. The exact dimming protocol must be confirmed to allow the selection of suitable drivers or bluetooth devices.

^ Depth indicated is the minimum recess depth for the luminaire with a remote mounted LED driver. Installing a driver through either the luminaire cut-out or installation kit may require additional recess depth, please refer to the relevant luminaire installation instructions for further details.Data correct at time of publishing

First Fix Requirement. Luminaire comprised of fixture body with ceiling trim and installation kit, which is to be fitted into the ceiling once finished. Ensure correct alignment of the installation kit before final assembly (see luminaire instllation instructions for details)

IP Rating. Tested from underside of the ceiling

It is the policy of Lucent Lighting to continually review and improve its products and therefore reserve the right to change any details of product or withdraw specifications without prior notice.

Luminaires designed to comply with EN60598 and all other standards.

This specification sheet superseded all previous versions.

All intellectual property rights pertaining to the product described above and to this document are owned by or licensed to Lucent Lighting Ltd.

We reserve the right to take whatever action is necessary to protect those intellectual property rights.

Please notify Lucent Lighting Ltd of any inaccuracies immediately. E&OE

