

# Installation Instructions

For Micro40 Disc

 **MAINS POWER TO BE SWITCHED OFF DURING INSTALLATION.**

Cut hole as follows:	
Micro40 Disc	Ø 1.06" / 27mm

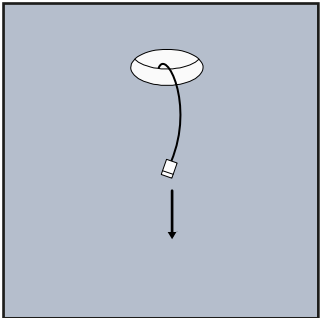
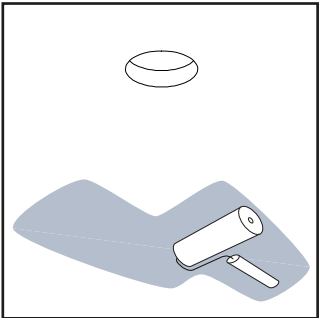
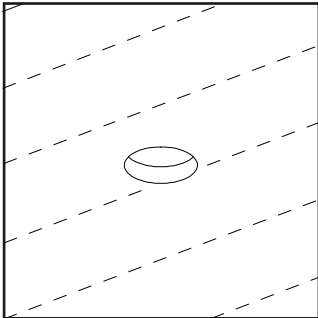

1. Plasterboard cutout size

2. Plasterboard installation cutout

3. Finish ceiling and allow to dry fully

4. Dropdown of power supply connector

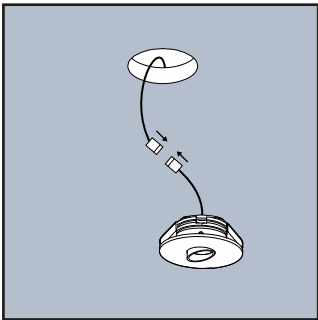

5. Fixture wiring connection

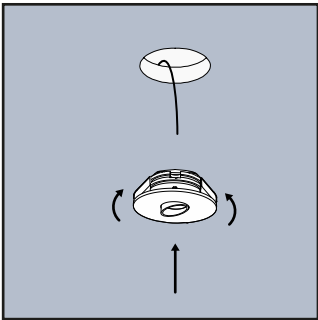

6. Press springs toward the luminaire body and insert into the ceiling cut-out

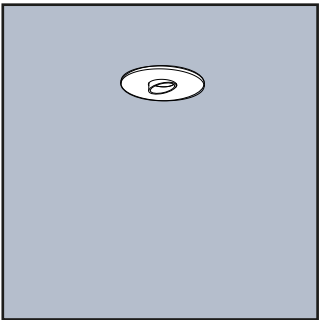

7. Finished Installation

Note:  
Driver will need to be installed remotely depending on if will not install through the installation kit. Refer to the driver manufacturers information for maximum cable runs and cable size.