

Installation Instructions: ProSpex Plus XL Round with Trim

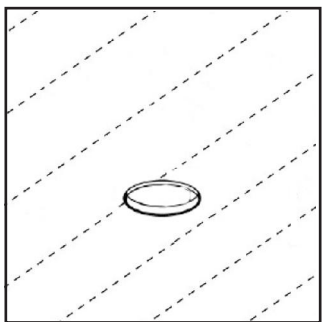

**MAINS POWER TO BE SWITCHED OFF
DURING INSTALLATION.**



**1) Cut hole as follows:
140mm diameter.**

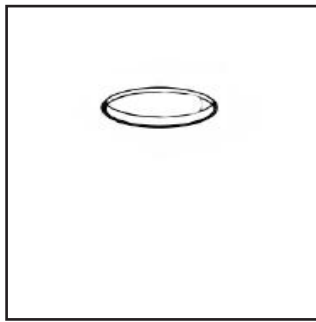

**2) Finish the ceiling face as
required.**

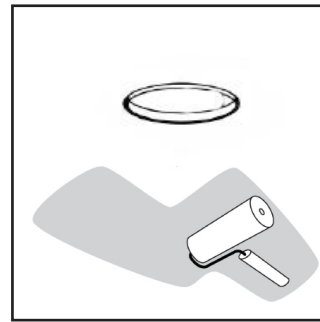

3) Paint the ceiling as required.

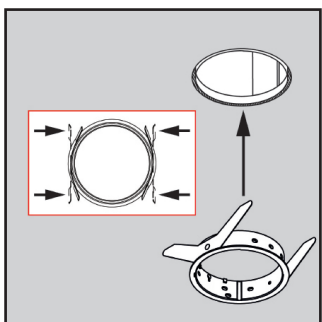

**4) Install the trim kit. Note
alignment marks and fit
accordingly (see note typeWW).**

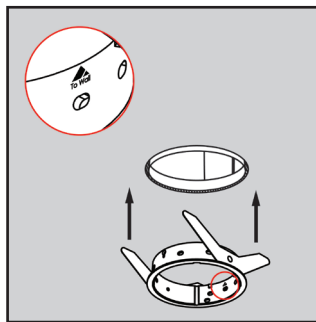

**Note Wallwash:
Install trim kit with mark "To
Wall" with Wall to be lit.**

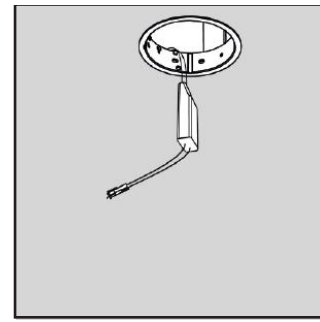

5) Install driver/control gear.

Fixed fitting ref 090+XL-xx-TR / 090+XL-33-xx-TR

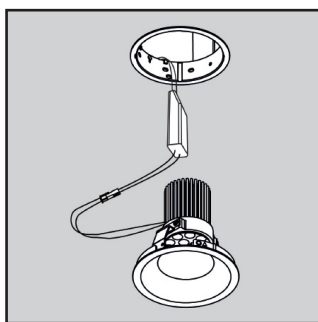

1) Connect the control gear.

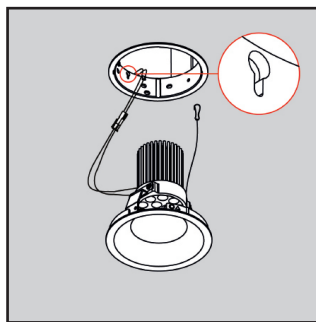

**2) Fit safety chain through the
keyhole slot.**

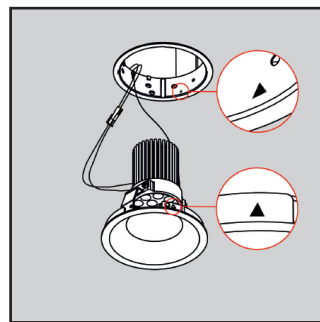

3) Align with indicator marks.

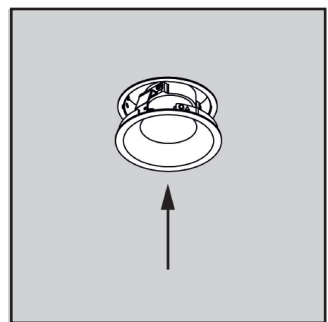

**4) Install the body into the
installation kit.**

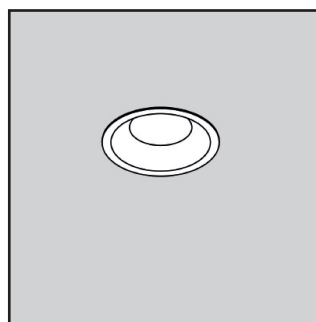

5) Installation is complete

Fixed fitting ref 090+XL-xx-TR / 093+XL-33-xx-TR

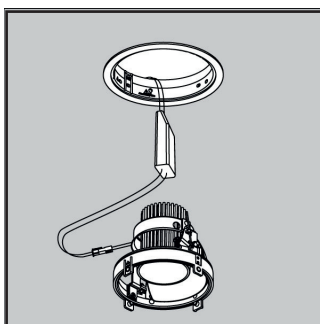

1) Connect the control gear.

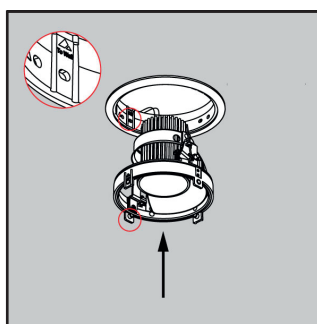

2) Align the body with the installation kit and fit.

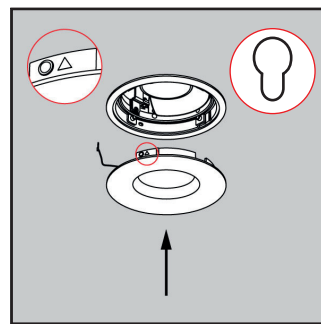

3) fit safety chain into keyhole slot.

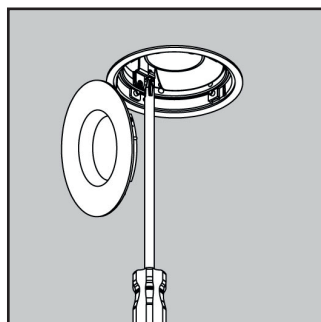

4) Adjust rotation using screwdriver.

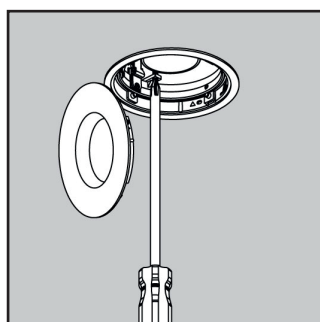

5) Adjust tilt using screwdriver.

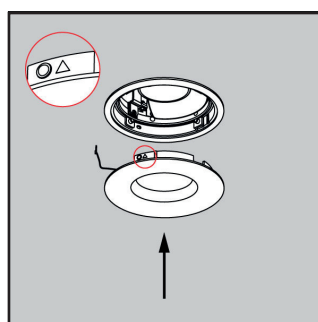

6) Align cover with indicator and fit.

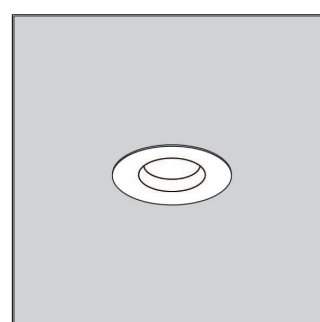

6) Installation is complete.

Fixed fitting ref 090+XL-xx-TR-WW

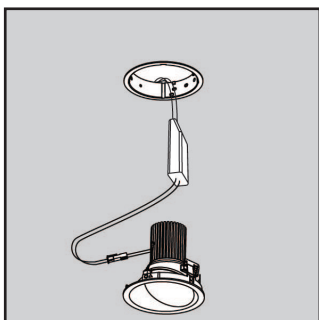

1) Connect the control gear.

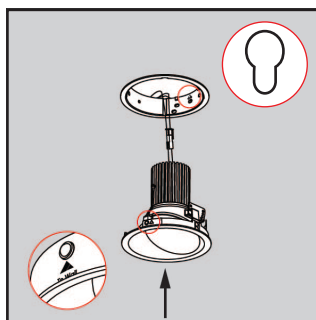

2) Attach safety wire to keyhole
Align body with trim kit. Install.

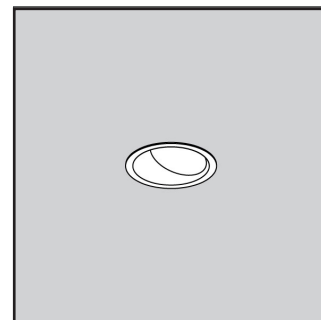

3) Installation is complete

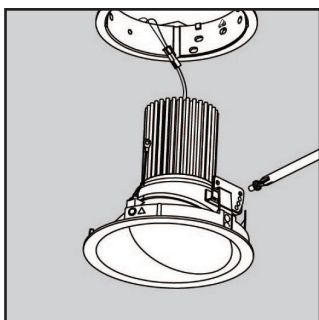

If required, adjust the module angle by removing the screw from position 0.

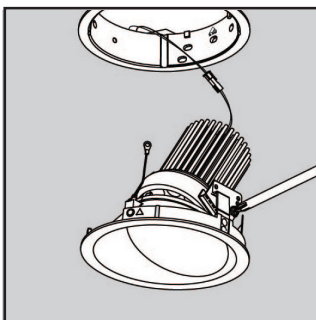

Reposition module and reinstall the screw in the required position.