

## TubeLED Micro Installation Instructions

TubeLED Micro  
6100-LVTR

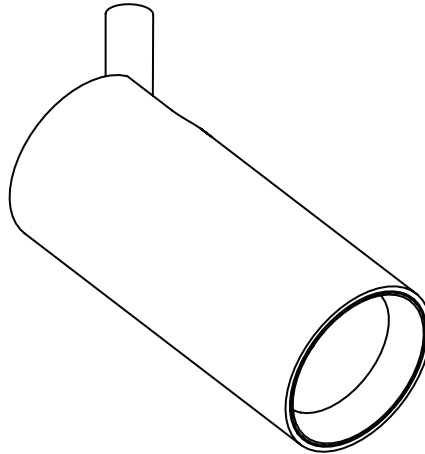

## Technical Parameters

Luminaire Type	Drive Current	Forward Voltage	LED Power
6100-LVTR	350mA max.	18VDC	6.3W
6100-RMP	350mA max.	18VDC	6.3W
6100-TMP	350mA max.	18VDC	6.3W
6100-SMP	350mA max.	18VDC	6.3W
6100SS-LVTR	700mA max.	11.5VDC	8.0W
6100SS-RMP	700mA max.	11.5VDC	8.0W
6100SS-TMP	700mA max.	11.5VDC	8.0W
6100SS-SMP	700mA max.	11.5VDC	8.0W

**Note:** The recommended cable distance between the remote driver and the light source is 2 meters for most driver types. If distances greater than this are required please contact Lucent Lighting for alternative solutions.



## IMPORTANT INFORMATION

- Please read the following instructions carefully.
- Follow all national and local wiring and safety regulations.
- Connecting or disconnecting these luminaires while powered will damage the LED.
- Do not touch the LED or PCB.
- These products are designed for interior use only and only for downlighting applications.
- Suitable for operation in ambient temperatures between -25°C and +40°C in free flowing air.
- These products should only be installed by a qualified electrician.
- The light source contained in these luminaires shall only be replaced by the manufacturer, their service agent or a similarly qualified person.
- These products require an LED driver - DO NOT CONNECT DIRECTLY TO MAINS POWER!
- The fixing method is designed to hold the weight of the luminaire only.
- The top and bottom of the luminaire provides essential heat dissipation for the light source and must not be covered.
- The manufacturer bears no liability for damage caused by inappropriate use or application.
- Retain these instructions for future reference.

## Product Information

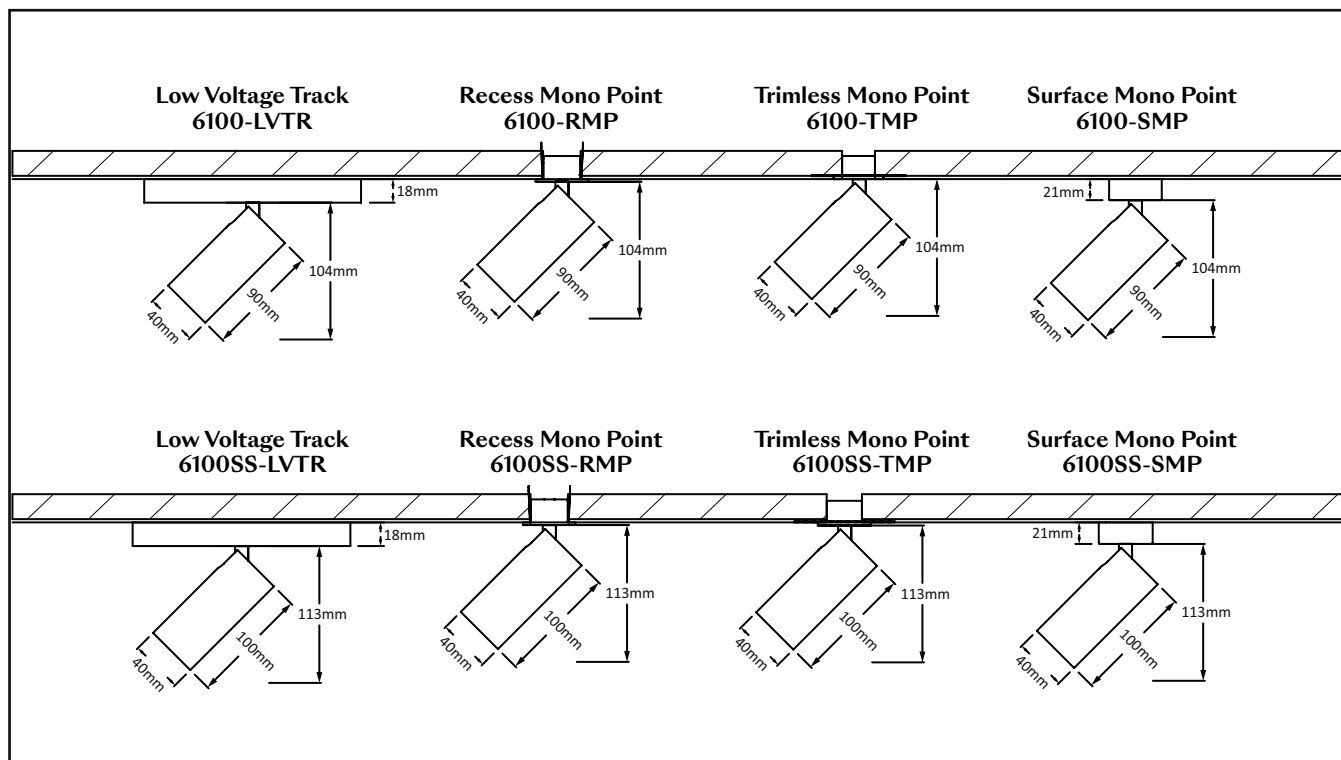

## Installation Steps

### TubeLED Low Voltage Track Application



**TURN POWER OFF BEFORE INSPECTION, INSTALLATION OR REMOVAL AND PROPERLY GROUND ELECTRICAL ENCLOSURE!**

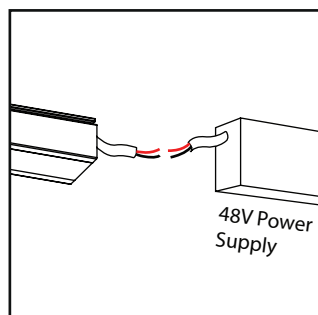

1. Connect 48V DC constant voltage power supply to Low Voltage Track. Check the overall power required.

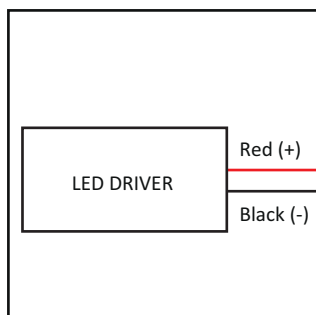

2. Locate LED Driver in remote location. Note the wire polarity.

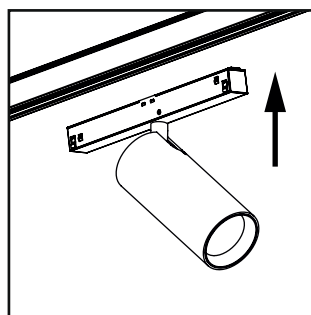

3. Insert the track adaptor into the track slot.

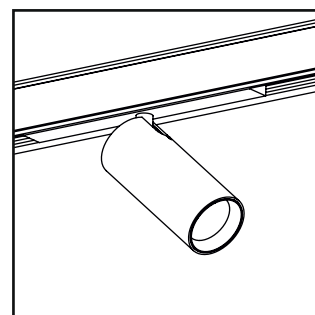

4. Clip the spotlight into the track adaptor and ensure it is fitted securely.

## TubeLED Recessed Mono Point Installation

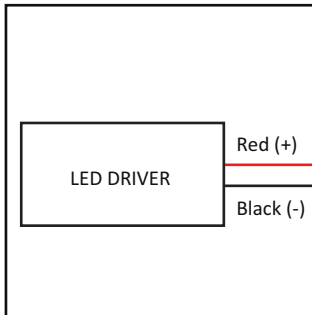

1. Locate LED Driver in remote location. Note the wire polarity.

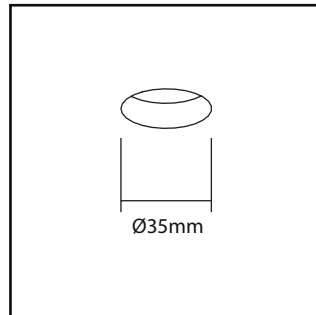

2. Create Cable Hole Ø35mm in ceiling.

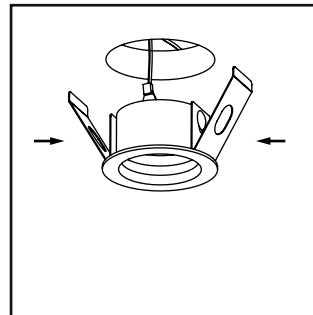

3. Push the springs inward and insert the Trim Kit.

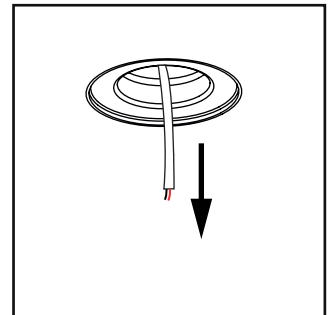

4. Drop-down driver connection from remote driver.

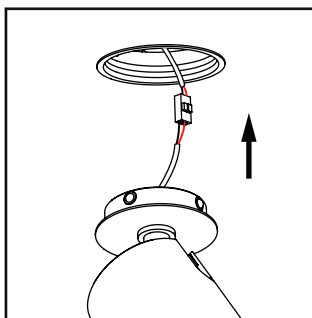

5. Clip and connect the security cable and make the electrical connection.

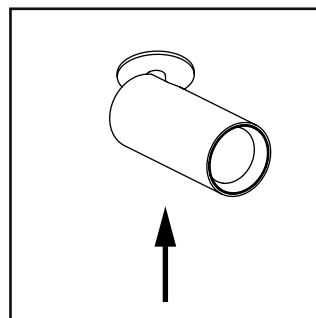

6. Clip and push spotlight top plate into the Trim Kit.

## TubeLED Surface Mono Point Installation

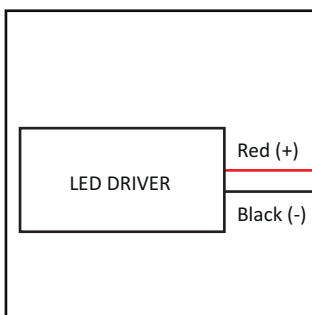

1. Locate LED Driver in remote location. Note the wire polarity.

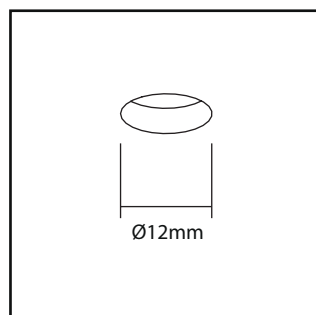

2. Create Cable Hole Ø12mm in ceiling.

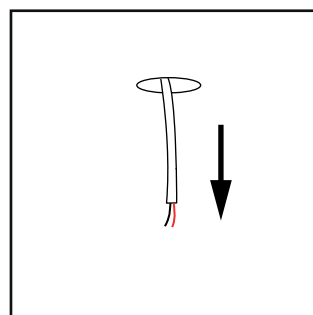

3. Drop-down driver connection from remote driver.

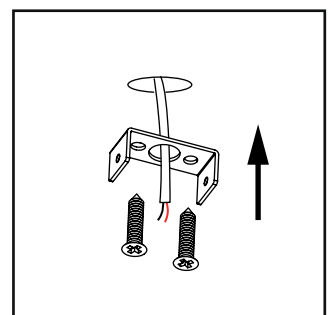

4. Mark fixing hole centres and fix bracket to ceiling with screws.

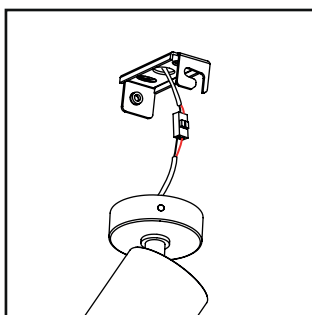

5. Make the electrical connection.

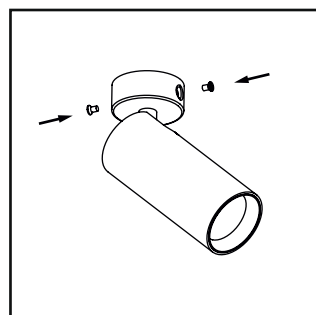

6. Place ceiling canopy over bracket and secure with screws provided.

## TubeLED Trimless Recessed Mono Point Installation

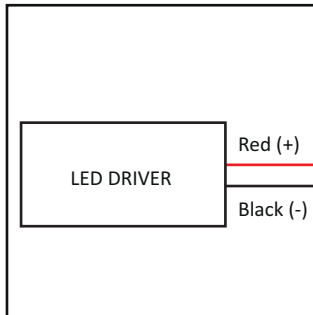

1. Locate LED Driver in remote location. Note the wire polarity.

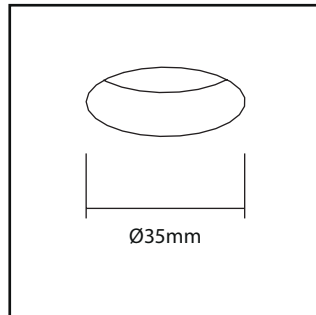

2. Create Cable Hole Ø35mm in ceiling.

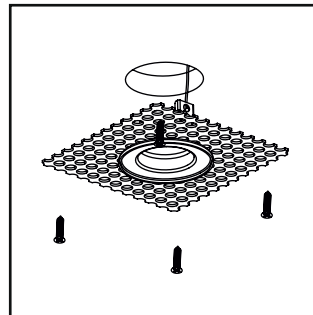

3. Insert Trimless Kit into ceiling hole and screw to fix Trimless Mesh to ceiling tightly.

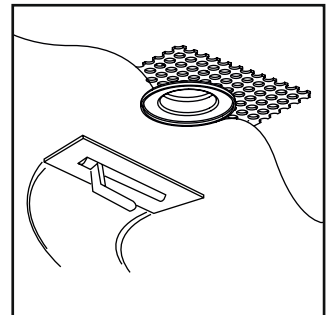

4. Plaster to cover the mesh and allow to dry.

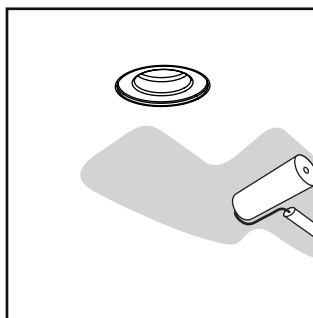

5. Paint and allow to dry fully.

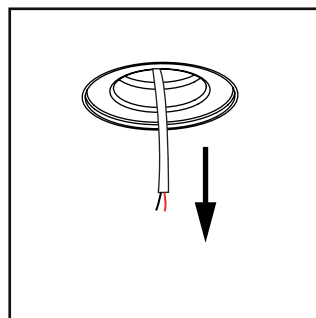

6. Drop-down driver connection from remote driver.

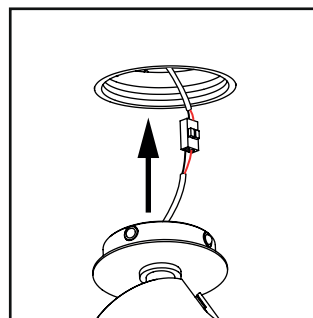

7. Make the electrical connection.

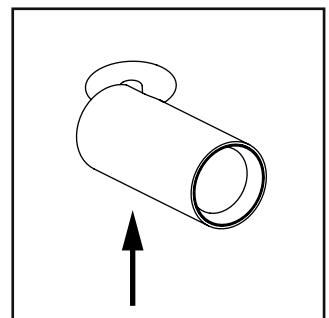

8. Clip and push spotlight top plate into the Trimless Kit.

## Accessories Instructions

Pull out Accessory Baffle and release the fixing spring to change the accessories.

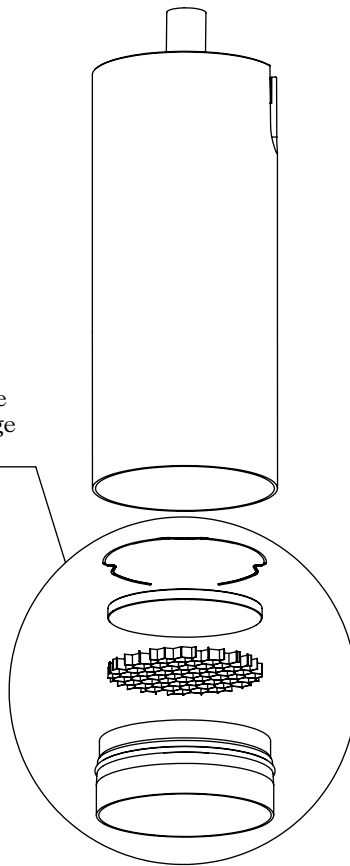

## DISCLAIMER

It is the policy of Lucent Lighting to continually review and improve its products and therefore reserve the right to change any details of product or withdraw specifications without prior notice. Luminaires designed to comply with EN60598 and all other standards. This specification sheet supersedes all previous versions. All intellectual property rights pertaining to the product described above and to this document are owned by or licensed to Lucent Lighting Ltd. We reserve the right to take whatever action is necessary to protect those intellectual property rights. Please notify Lucent Lighting Ltd of any inaccuracies immediately. E&OE