

Installation Instructions for Trim Square Fixed/Accent

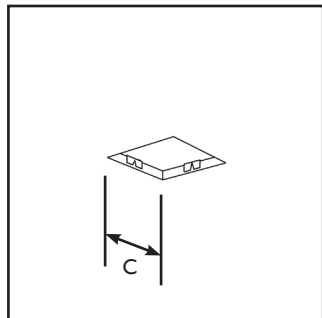

MAINS POWER TO BE SWITCHED OFF DURING INSTALLATION.



2. Plasterboard installation
Cutout (C): 3.29" x 3.29"
(83.5 x 83.5mm)

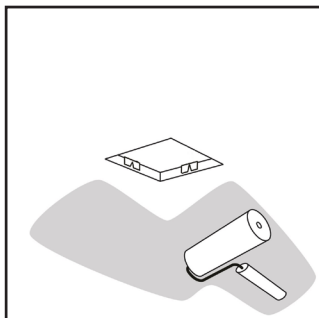

4. Paint and allow to dry fully

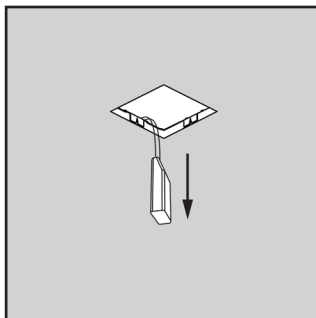

5. Dropdown of power supply

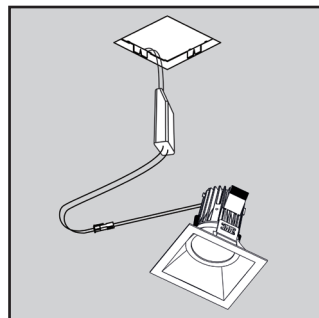

6. Fixture wiring connection

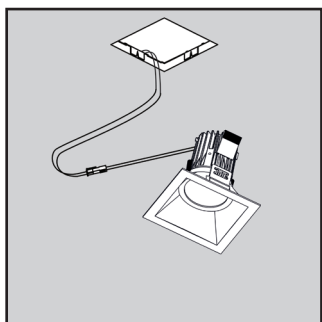

7. Power supply re-installtion

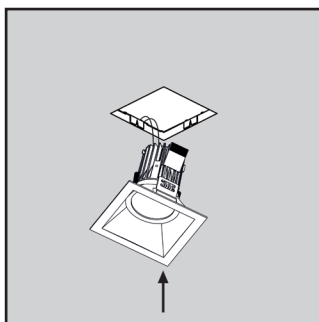

8. Carefully raise the springs to allow fixture to pass through the cutout. Once in position the tension of the springs will hold the luminaire in position.

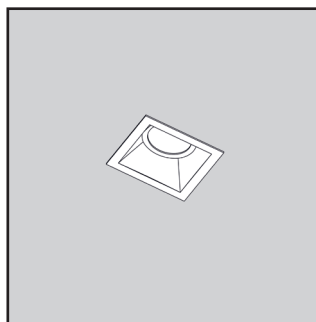

9. Finished installation

Fixture Adjustment Instructions

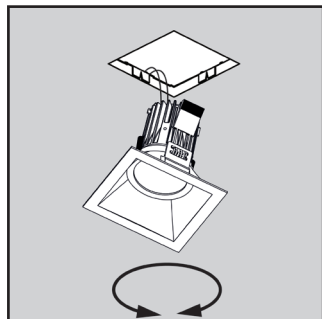

1. Adjust rotation before installing
fitting into cutout, in 90° increments.

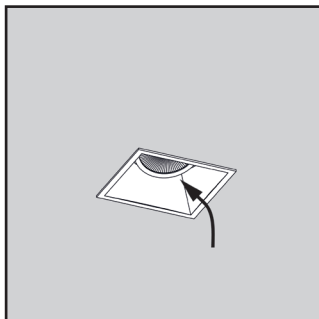

2. Adjust tilt.

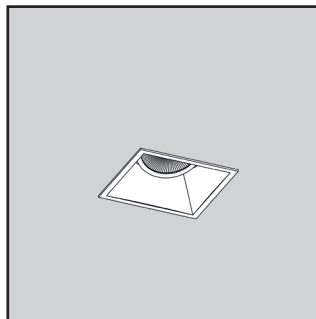

3. Finished.

LED Modules Instructions

Installation and servicing of Lucent LED modules should always be carried out by a qualified and competent person, in conjunction with these instructions for the LED modules and the particular Lucent light fittings instructions.
For further information or assistance contact Lucent Lighting.

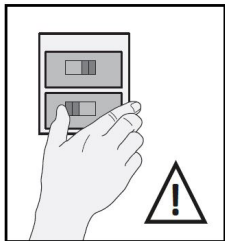

Switch off mains power before installation or servicing.

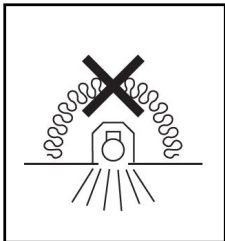

Do not cover luminaire & LED module with insulation material.

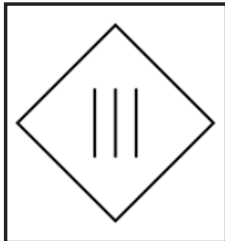

Lucent LED modules are all insulation class III. Drivers used must be SELV (<60Vdc)

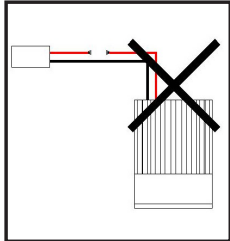

LED lead, if damaged, lead cannot be replaced, the LED module is to be replaced.

LED Module	Drive Current	Typ. forward volt	Mod. Power
LED35/2 LED35/U	350mA max.	18vdc	6.3w max.
LED51/2 LED51/U	350mA max	33vdc	11.6w
LED71 - LED71/U	700mA max	33vdc	23.1w
LED51WD	500mA	29.1vdc	15.6w
LED51TW	700mA	18.4vdc per Ch.	12.6w max. per CH.
LED71WD	1000mA	23.0vdc	23.0w
LED71TW	1000mA	23.4vdc per Ch.	23.4w max. per Ch.

Leave the minimum distances above fixture detailed below.

LED35 modules, min. 0.59" (15mm)
LED51 modules min. 0.98" (25mm)
LED71 modules min 0.98" (25mm)

Note some driver and fitting combinations may require a bigger recess depth to install driver.

Servicing LED modules.

Lucent LED modules are **non user** replaceable. LED modules should only be replaced a qualified person, the manufacturer or a similar qualified person.

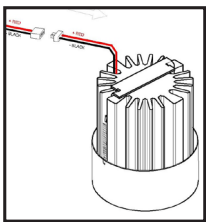

Switch off mains power.
Disconnect LED module from the driver.
Take off the fixing brace by removing the hooked spring to free the LED module.

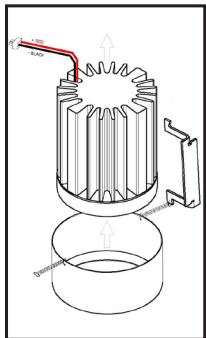

Remove the LED module.
Reverse process to re-install the LED module and re-connect to the driver before turning on the mains power.

All LED drivers supplied by Lucent will be pre-wired with a lead that has the correct connector to match the LED module used.
If connectors removed, warranty will be void.
If the driver needs to be replaced, or cables extended refer to following wiring diagrams.

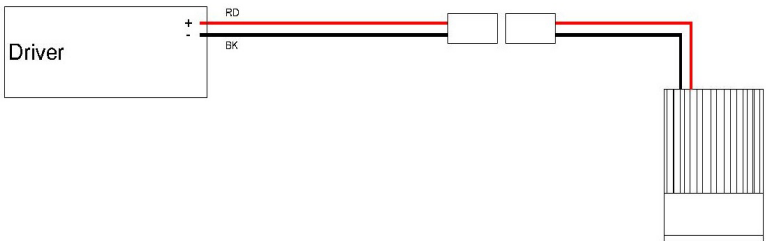

For LED35/2, LED51/2, LED71, ULTRA & LED51WD, LED71WD.
Refer to specific driver connections for the exact driver terminals configuration.

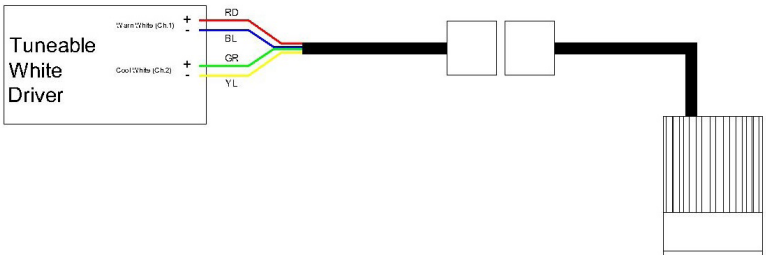

For LED51TW & LED71TW
Refer to specific driver connections for the exact driver terminals configuration.



The Luminaire should be positioned so that prolonged staring into the luminaire at a distance of 1.68m is not expected (applies ONLY to LED71 & LED71/U modules).