

ProSpex100 Wallwash

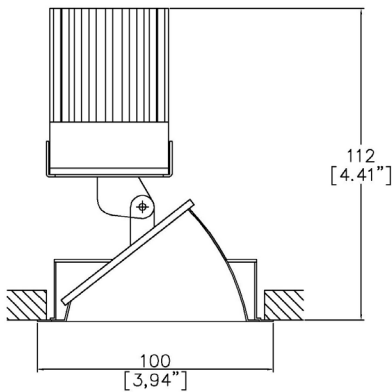

100mm (3.94”) overall diameter. Available with stand-ard trim kit or plaster-in kit for flush appearance. Family of matching products also available. Required depth height + 25mm^



100-LED-WW

LED Source	LED51WD
CCT	3000K
Drive Current	500mA
Power inc Driver	17.1W
Beam Angle	39°
Delivered Lumens	404
Delivered Intensisty cd	450
Efficacy lm/w	24
Forward Volt	29.1V
CRI	≥95 CRI

Project Ref: _____ Location Ref: _____

Fixture Order Code: - - - -

Fixture	100-LED-WW	Reflector100 Wallwash with LED51
Reflector Finish		
PS		Polished Silver
SS		Satin Silver
CG		Champagne Gold
BK		Black
WH		White
Trim Finish		
WH		White
BK		Black
RAL		Custom RAL Colour*
IP Rating	54	IP54
Emergency		
E		Maintained 3hr Emergency
ED		Maintained 3hr DALI Self Test
ES		Maintained 3hr Self Test

LED Order Code: - - -

LED	LED51WD	LED50 ONE Ambiance WarmDim
CCT		
2720		2700K - 2000K
3020		3000K - 2000K
Beam	39	39°
Protocol		
S		Non-Dim
A		Analogue (0-10v)
P		Phase
D		DALI
B		Bluetooth**

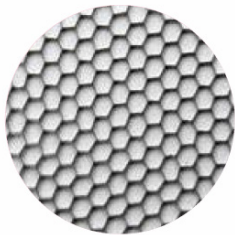

Honeycomb Louvre



Warm Tone

Accessories Order Code:

Louvre/Lens

- LL45 Honeycomb Louvre
- LLCC Warm Tone Lens
- LLUV UV Lens

Technical Details

*Custom RAL code must be specified. Custom RAL colours can increase prices and lead times

Dimming. Whilst Lucent can offer the majority of its luminaires with various dimming options, it remains the responsibility of the specifier/installer to check and ensure compatibility of any control equipment used. Additional cabling may be required depending on the dimming protocol specified.

**Bluetooth (wireless) is the communication method. The exact dimming protocol must be confirmed to allow the selection of suitable drivers or bluetooth devices.

^ Depth indicated is the minimum recess depth for the luminaire with a remote mounted LED driver. Installing a driver through either the luminaire cut-out or installation kit may require additional recess depth, please refer to the relevant luminaire installation instructions for further details.Data correct at time of publishing

First Fix Requirement. Luminaire comprised of fixture body with ceiling trim and installation kit, which is to be fitted into the ceiling once finished. Ensure correct alignment of the installation kit before final assembly (see luminaire instllation instructions for details)

IP Rating. Tested from underside of the ceiling

It is the policy of Lucent Lighting to continually review and improve its products and therefore reserve the right to change any details of product or withdraw specifications without prior notice.

Luminaires designed to comply with EN60598 and all other standards.

This specification sheet superseded all previous versions.

All intellectual property rights pertaining to the product described above and to this document are owned by or licensed to Lucent Lighting Ltd.

We reserve the right to take whatever action is necessary to protect those intellectual property rights.

Please notify Lucent Lighting Ltd of any inaccuracies immediately. E&OE

Light efficiency:

24 Lumen/Watt

Light quality:

CRI: 95.4

Color temperature:

3000 K

54.7°

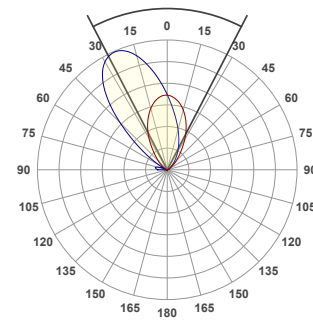

Product name:

100-LED-SS-WW-30 Dgr Tilt - LED51WD-3020-39-500mA

Item number:

ProSpex 100 Wallwash Satin Silver Reflector - LED51WD-3020-39-500mA

Delivered information for above fixture and LED combination.

Output: 404 Lumen Peak intensity: 450 cd Power consumption: 17.1

CRI R values

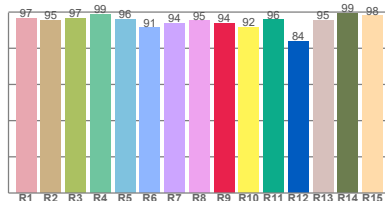

TM30 C Values

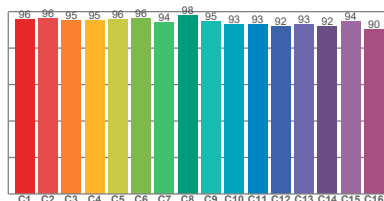

Color vector graphics

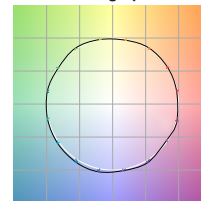

Color temperature	Color rendering Index	Red component	Color fidelity	Color gamut	Color quality scale	Color coordinate cie 1931	Color coordinate cie 1931	Color coordinate	Color coordinate	Color deviation from black body
CCT	CRI	CRI R9	TM30 Rf	TM30 Rg	CQS	x	y	u	v	Δuv
3000 K	95.4	93.9	94.3	101.9	94.3	0.437	0.404	0.256	0.342	-0.0066

Beam details

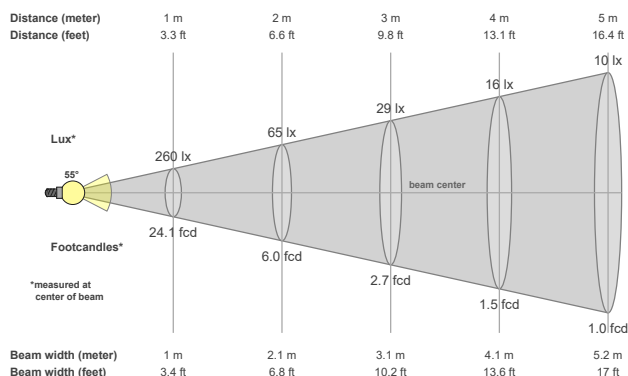

Beam angles

Beam angle 50%	Field angle 10%	Cutoff angle 2,5%
54.7°	99.8°	135.7°

Beam intensities

Peak intensity	Int. ratio in 120° cone	Int. ratio in 90° cone
450 cd	94.3%	80.6%

Beam intensities from 1-20m

1m	2m	3m	4m	5m	6m	7m	8m	9m	10m	11m	12m	13m	14m	15m	16m	17m	18m	19m	20m
3.3ft	6.6ft	9.8ft	13.1ft	16.4ft	19.7ft	23ft	26.2ft	29.5ft	32.8ft	36.1ft	39.4ft	42.7ft	45.9ft	49.2ft	52.5ft	55.8ft	59.1ft	62.3ft	65.6ft
260lx	65lx	29lx	16lx	10lx	7lx	5lx	4lx	3lx	3lx	2lx	2lx	2lx	1lx	1lx	1lx	1lx	1lx	1lx	1lx
24.1fcd	6fcd	2.7fcd	1.5fcd	1fcd	0.7fcd	0.5fcd	0.4fcd	0.3fcd	0.2fcd	0.2fcd	0.2fcd	0.1fcd	0.1fcd	0.1fcd	0.1fcd	0.1fcd	0.1fcd	0.1fcd	0.1fcd

The above information is for 3000K colour temperature, for specific module information please see LED spec located on our website

For information regarding other colour temperatures please use the following factors for lumen output and candelas:

2700K =

4000K =