

## TubeLED Mini & Midi Installation Instructions

TubeLED Mini  
7100/2-LED

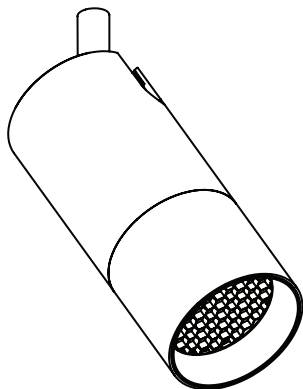

TubeLED Midi  
9100/2-LED

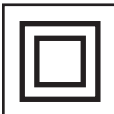
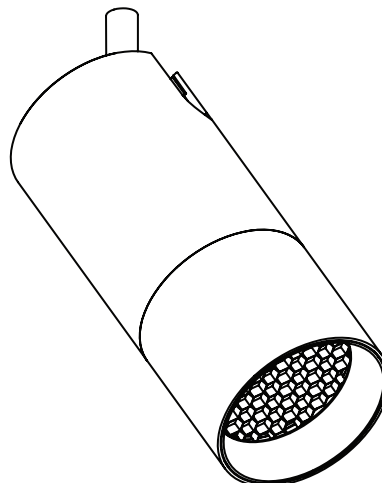

IP20



Ta  
≤25°C



## Technical Parameters

Luminaire Type	Drive Current	Forward Voltage	LED Power
7100/2-LED	350mA max.	36VDC	12.6W
7100SS-LED	1000mA max.	12.3VDC	12.3W
7100/2-LED-Z	500mA max.	36VDC	18W
7100WD	500mA max.	29.1VDC	14.6W
7100TW	700mA max.	18.4VDC	12.6W
9100/2-LED	500mA max.	36VDC	18W
9100WD	1000mA max.	23VDC	23W
9100TW	1000mA max.	23.4VDC	23.4W

**Note:** The recommended cable distance between the remote driver and the light source is 2 meters for most driver types. If distances greater than this are required please contact Lucent Lighting for alternative solutions.



## IMPORTANT INFORMATION

- Please read the following instructions carefully.
- Follow all national and local wiring and safety regulations.
- Connecting or disconnecting these luminaires while powered will damage the LED.
- Do not touch the LED or PCB.
- These products are designed for interior use only and only for downlighting applications.
- Optimal ambient temperature ≤ 25°C, operating range of components -20°C - +40°C.
- These products should only be installed by a qualified electrician.
- Lucent LED Spotlight's light source is non user replaceable.
- LED Spotlight's should only be replaced by a qualified person, the manufacturer or a similar qualified person.
- These products require an LED driver - DO NOT CONNECT DIRECTLY TO MAINS POWER!
- The fixing method is designed to hold the weight of the luminaire only.
- The top and bottom of the luminaire provides essential heat dissipation for the light source and must not be covered.
- The manufacturer bears no liability for damage caused by inappropriate use or application.
- Retain these instructions for future reference.

## Product Information

### TubeLED Mini Gen2

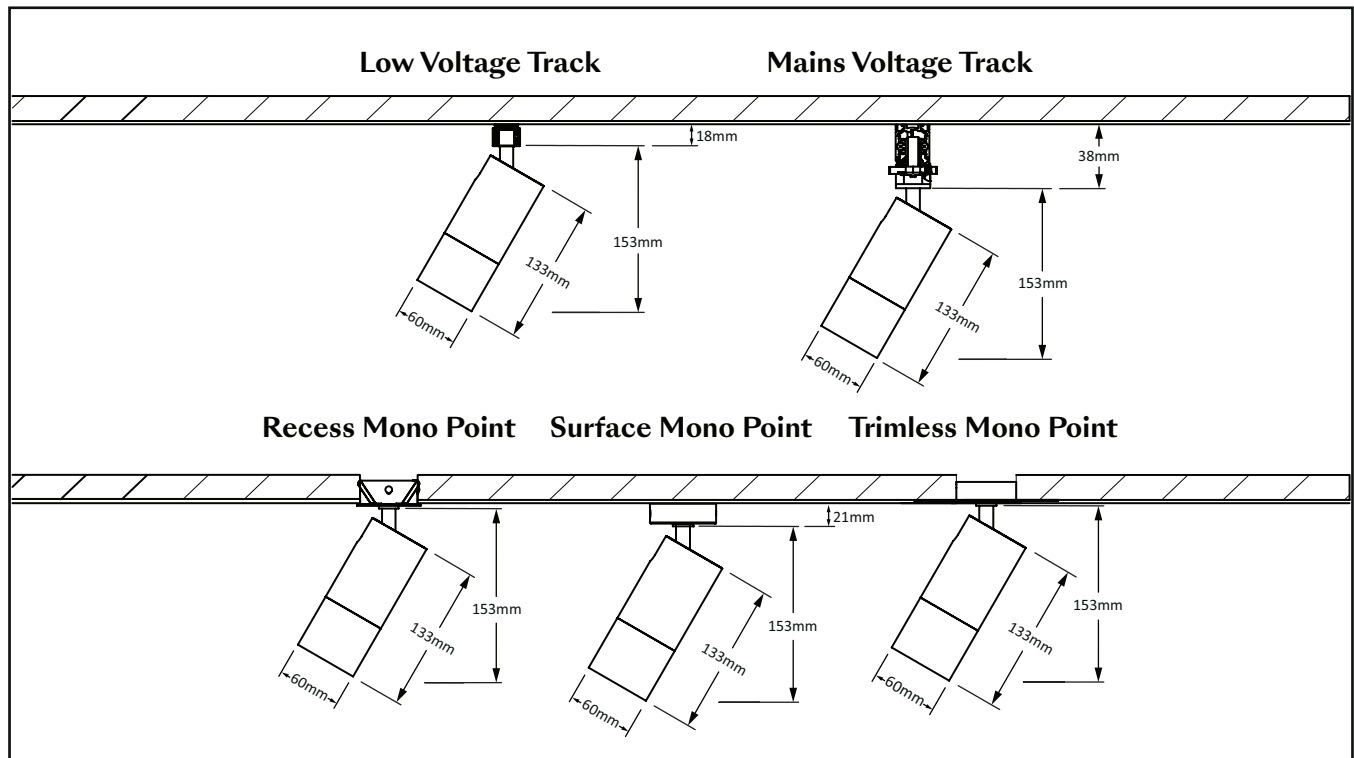

### TubeLED Midi Gen2

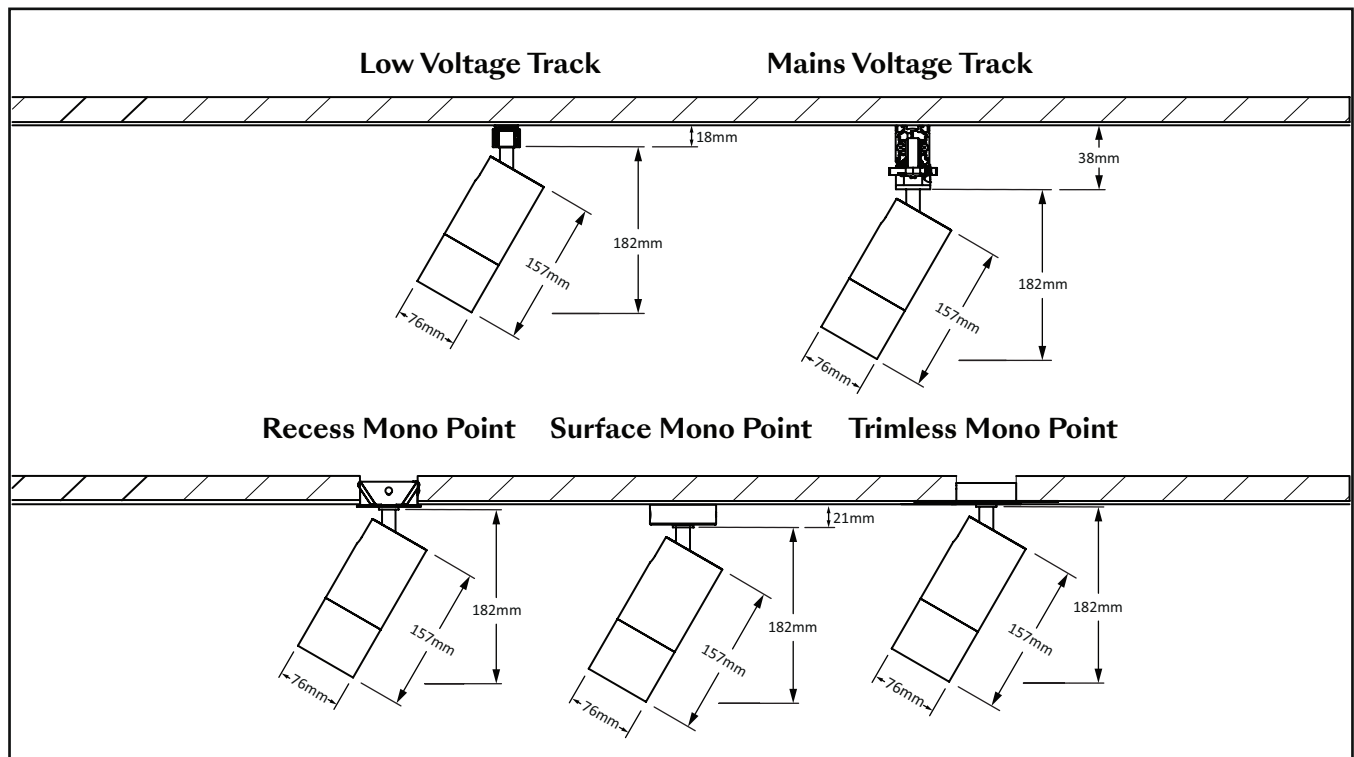

## Installation Steps

### TubeLED Low Voltage Track application



**TURN POWER OFF BEFORE INSPECTION, INSTALLATION OR REMOVAL AND PROPERLY GROUND ELECTRICAL ENCLOSURE!**

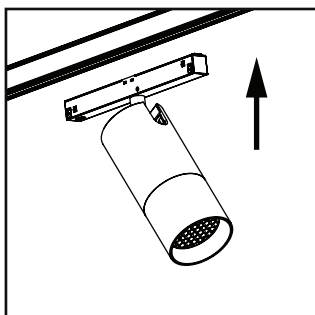

1. Insert the track adaptor into the track slot.

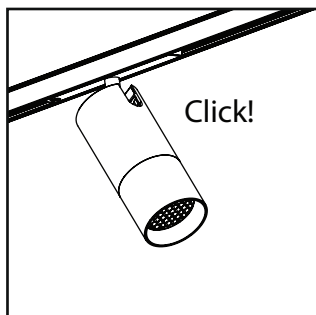

2. Clip the spotlight into the track adaptor and check whether it is fitted tightly

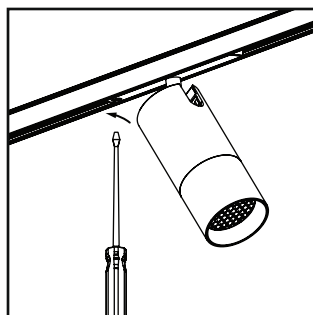

3. Screw the bracket onto the track tightly

### TubeLED Mains Voltage Track application

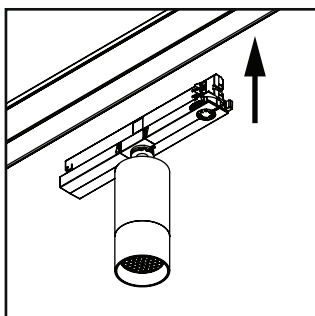

1. Twist to pull the conductive latch in and insert the track adaptor into the track slot

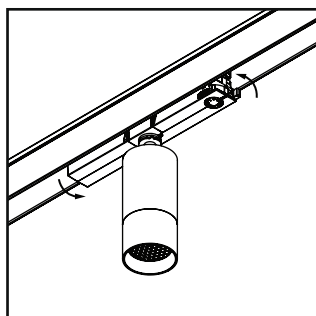

2. Once it is fitted tightly, twist the conductive latch anti-clock way to catch the track and fix the entire spotlight. But do not turn on the mains power until all of the spotlights light in the track have been installed completely

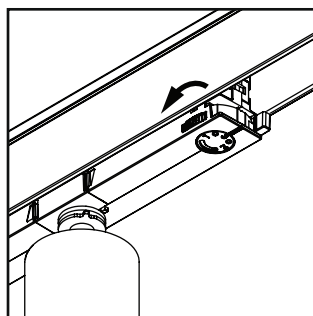

3. Switch track by turning the wheel

**Note:** For low voltage or main voltage track installation instruction, go to [www.lucent-lighting.com](http://www.lucent-lighting.com) and download the relevant spec pack.

## TubeLED Surface Mono Point installation

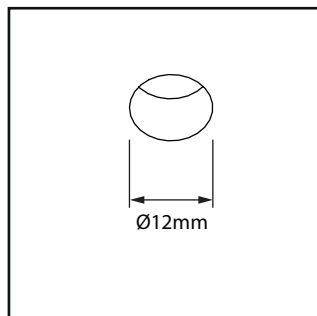

1. Create a cable hole Ø12mm

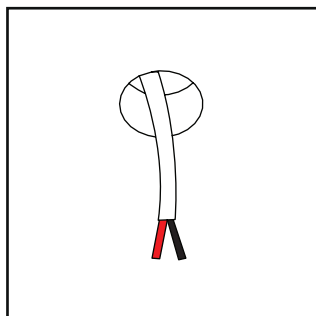

2. Feed cables through

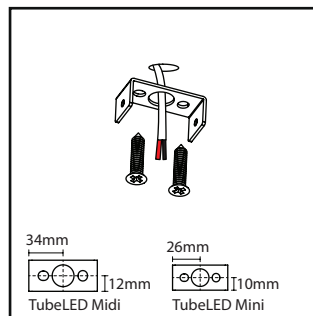

3. Feed cables through the bracket and secure the cable to the ceiling. Screw the bracket onto the ceiling tightly

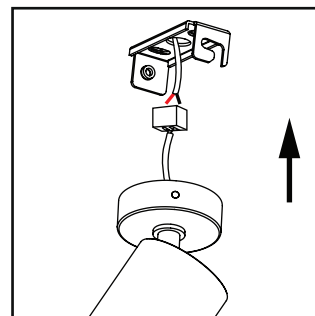

4. Make the electrical connection

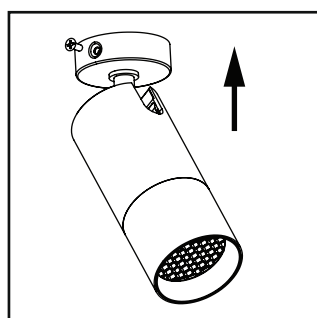

5. Place the ceiling canopy over the bracket and then secure with a screw provided

## TubeLED Recessed Mono Point Installation

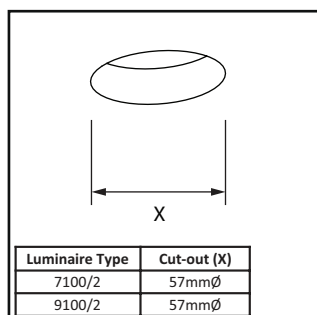

1. Cut-out to allow the installation of the luminaire

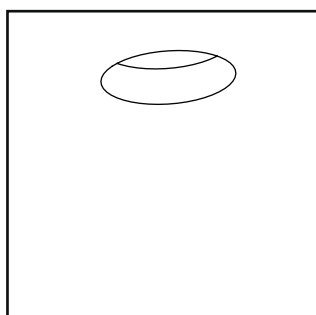

2. Finish the ceiling surface

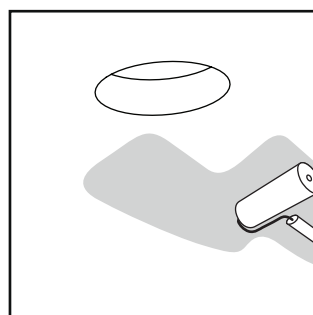

3. Paint and allow to dry fully

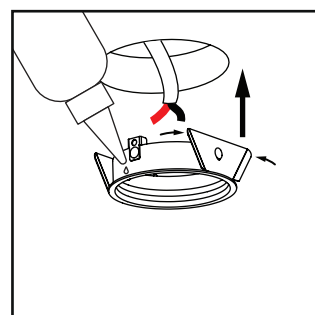

4. Bond installation collar. Push the springs inward and insert the Trim Kit

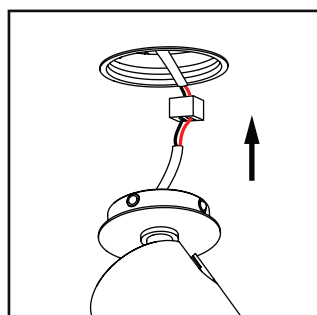

5. Clip and connect the security cable and make the electrical connection

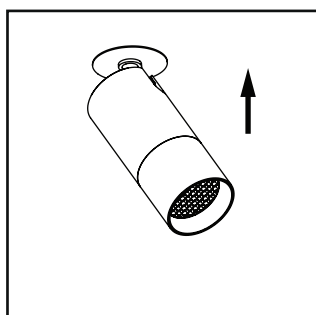

6. Clip and push spotlight top plate into the Trim Kit

## TubeLED Trimless Recessed Mono Point Installation

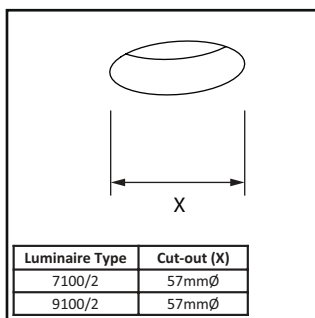

1. Cut-out to allow the installation of the luminaire

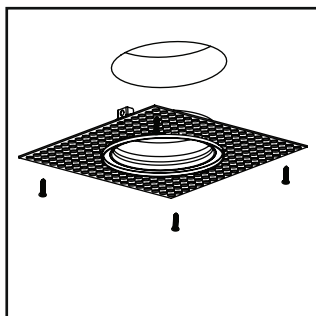

2. Insert the Trimless Kit into the ceiling hole and then screw to fix the Trimless Mesh on the ceiling tightly

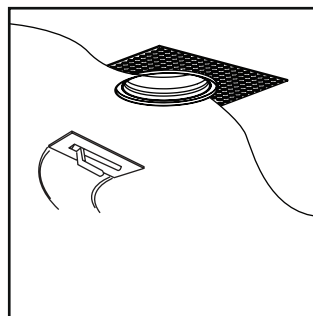

3. Plaster to cover the mesh and allow to dry

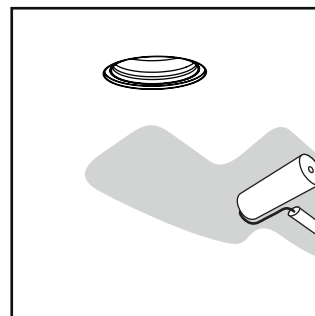

4. Paint and allow to dry fully

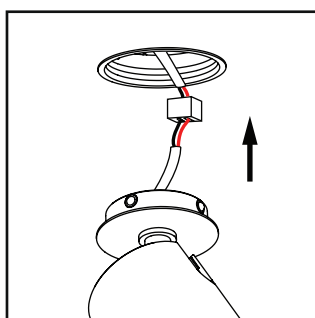

5. Clip and connect the security cable and make the electrical connection

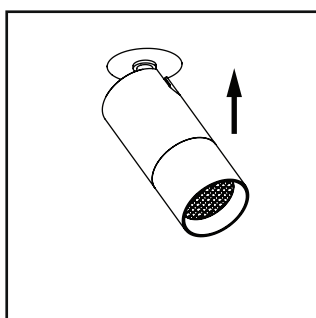

6. Clip and push spotlight top plate into the Trim Kit

## TubeLED Remote Driver Wiring

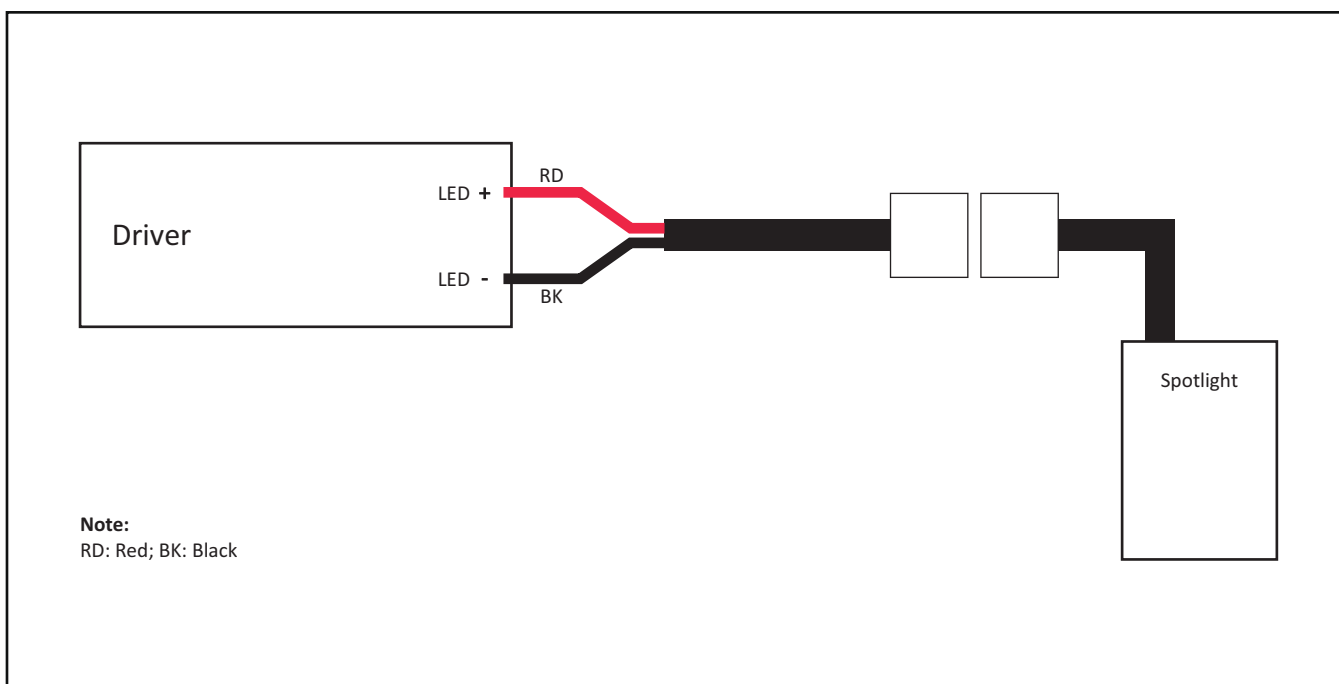

## TubeLED Tuneable White Surface Mono Point installation

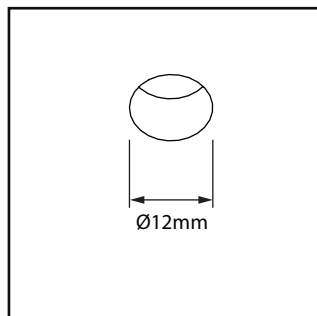

1. Create a cable hole Ø12mm

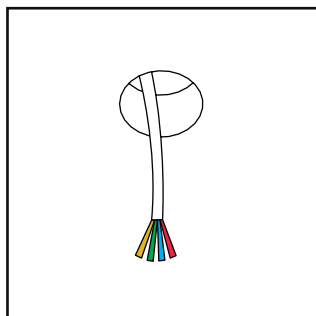

2. Feed cables through

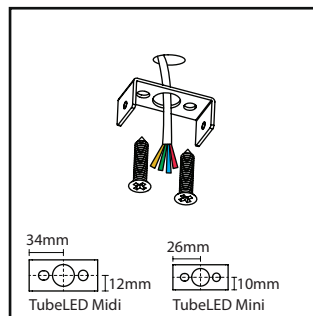

3. Feed cables through the bracket and secure the cable to the ceiling. Screw the bracket onto the ceiling tightly

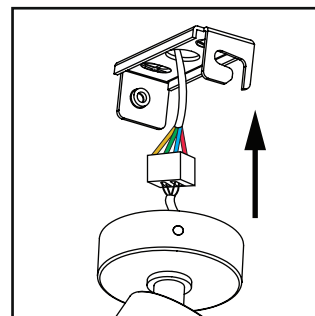

4. Make the electrical connection (Refer to TubeLED Tuneable White Remote Driver Wiring)

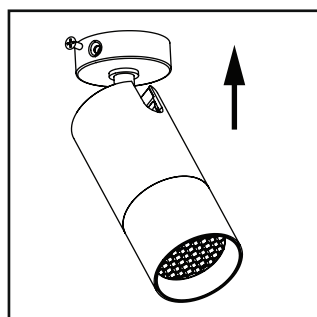

5. Place the ceiling canopy over the bracket and then secure with a screw provided

## TubeLED Tuneable White Recessed Mono Point Installation

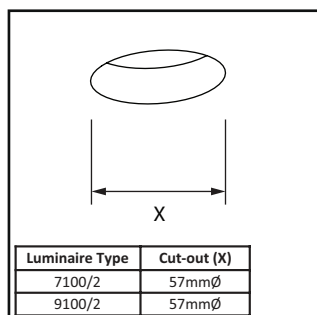

1. Cut-out to allow the installation of the luminaire

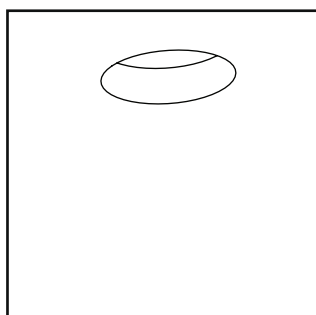

2. Finish the ceiling surface

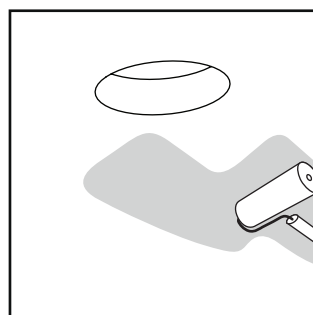

3. Paint and allow to dry fully

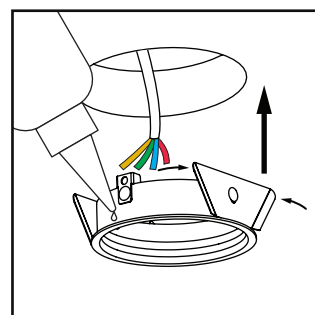

4. Bond installation collar. Push the springs inward and insert the Trim Kit

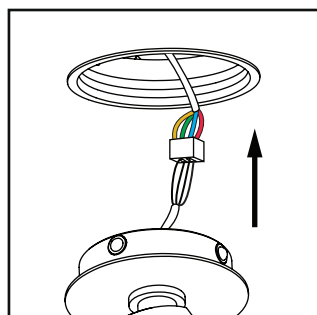

5. Clip and connect the security cable and make the electrical connection. (Refer to TubeLED Tuneable White Remote Driver Wiring)

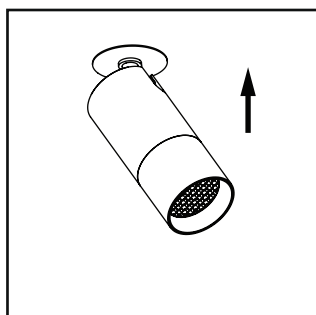

6. Clip and push spotlight top plate into the Trim Kit

## TubeLED Tuneable White Trimless Recessed Mono Point Installation

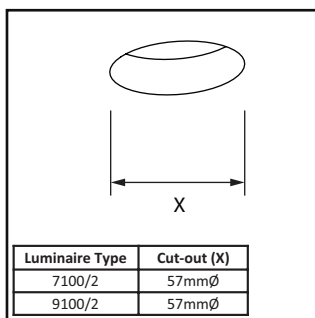

1. Cut-out to allow the installation of the luminaire

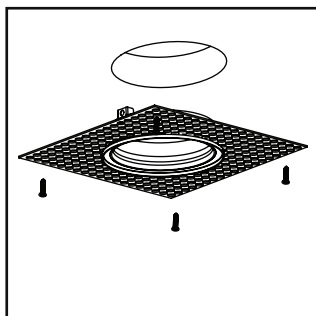

2. Insert the Trimless Kit into the ceiling hole and then screw to fix the Trimless Mesh on the ceiling tightly

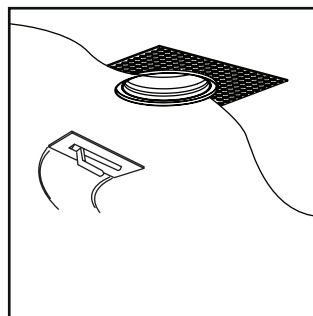

3. Plaster to cover the mesh and allow to dry

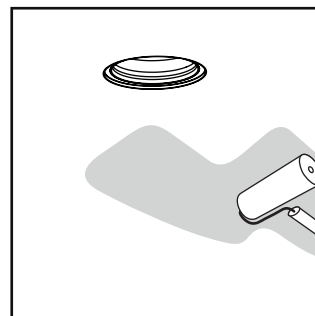

4. Paint and allow to dry fully

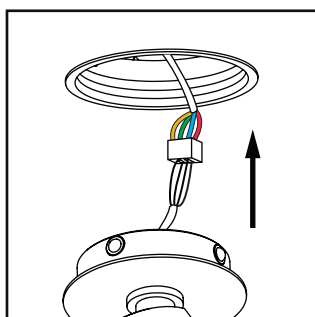

5. Clip and connect the security cable and make the electrical connection. (Refer to TubeLED Tuneable White Remote Driver Wiring)

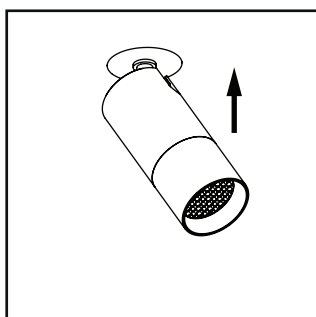

6. Clip and push spotlight top plate into the Trim Kit

## TubeLED Tuneable White Remote Driver Wiring

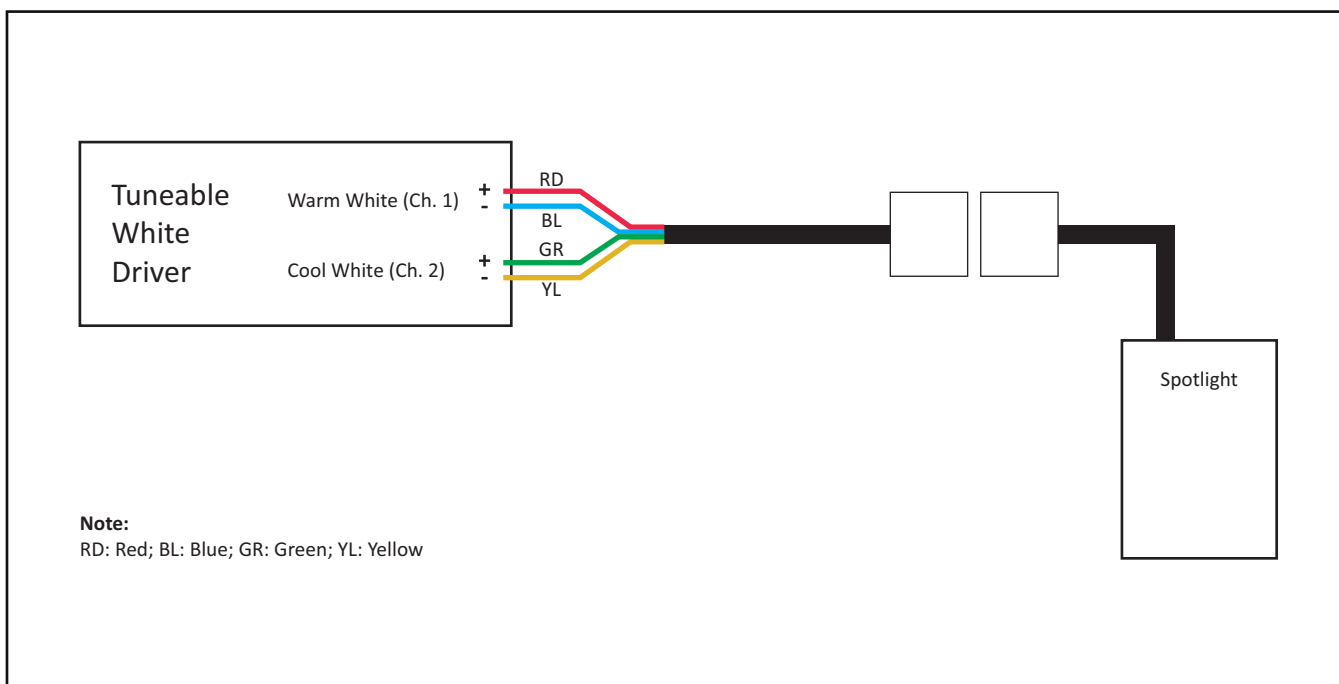

## Accessories Instructions

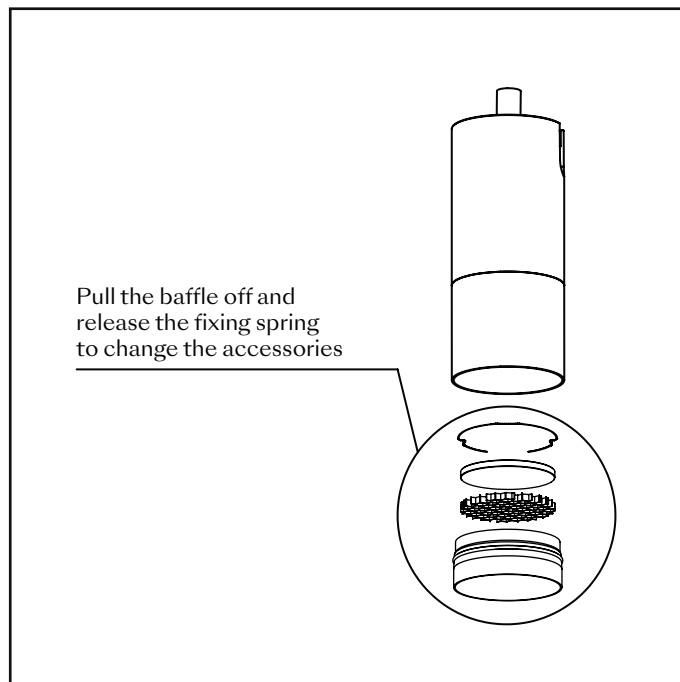

## Wallwash Information

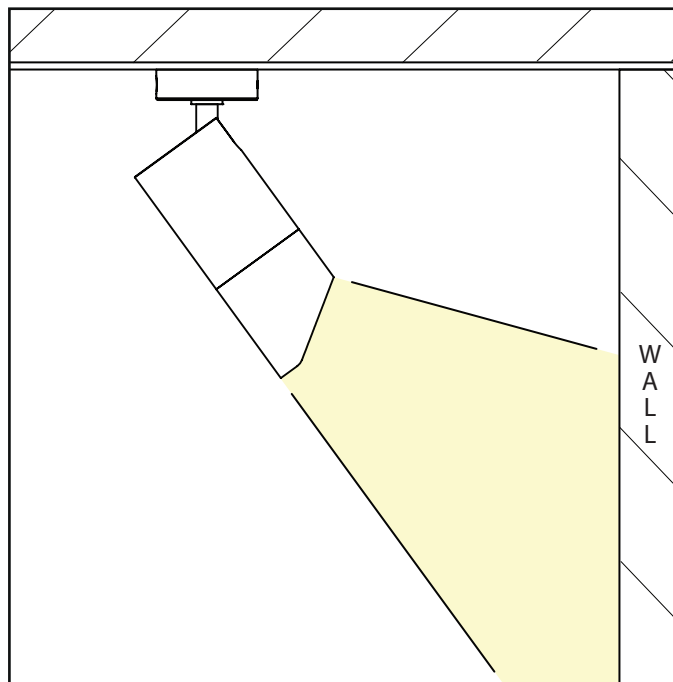

## TubeLED Zoom Adjustment Instructions

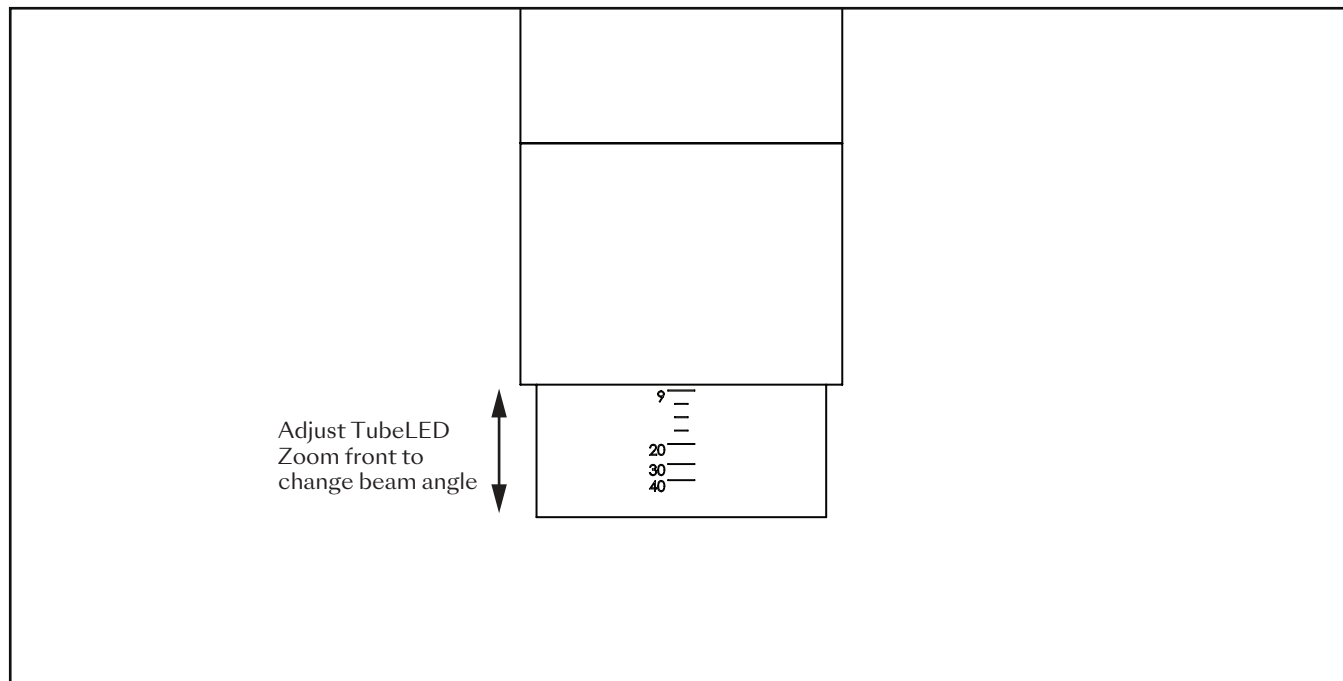

## DISCLAIMER

It is the policy of Lucent Lighting to continually review and improve its products and therefore reserve the right to change any details of product or withdraw specifications without prior notice. Luminaires designed to comply with EN60598 and all other standards. This specification sheet supersedes all previous versions. All intellectual property rights pertaining to the product described above and to this document are owned by or licensed to Lucent Lighting Ltd. We reserve the right to take whatever action is necessary to protect those intellectual property rights. Please notify Lucent Lighting Ltd of any inaccuracies immediately. E&OE