

Installation Instructions for Plus 3.5" Conical Flangeless Accent with Housing

For Insulated and Non-Insulated Ceiling type installations

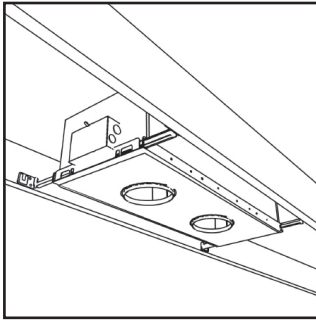

MAINS POWER TO BE SWITCHED OFF DURING INSTALLATION.



1. Fixing of housing

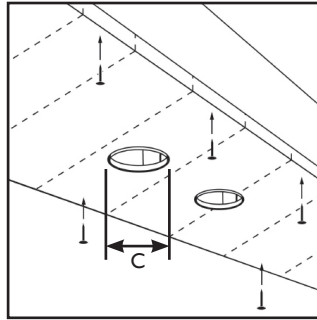

2. Plasterboard installation
Cutout (C): Ø4" (102mm)

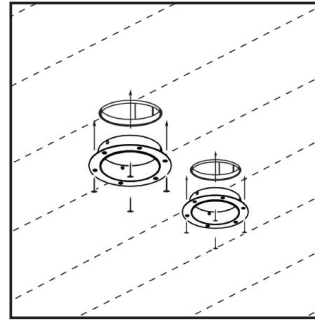

3. Trimless mud in kit installation

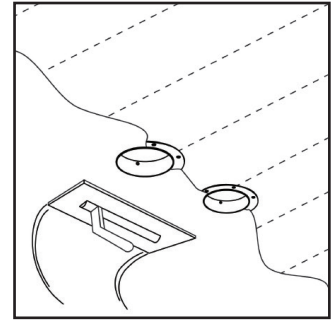

4. Mud in and allow to dry fully

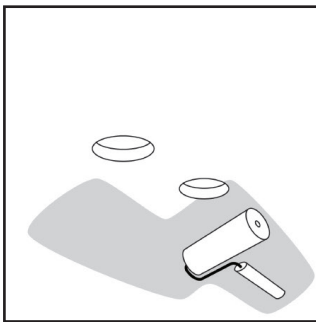

5. Paint and allow to dry fully

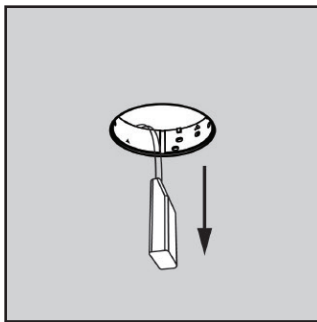

6. Dropdown of power supply

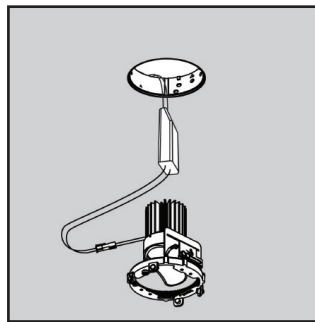

7. Fixture wiring connection

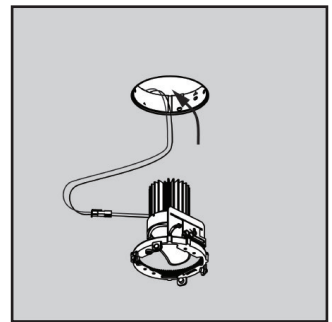

8. Power supply re-installation

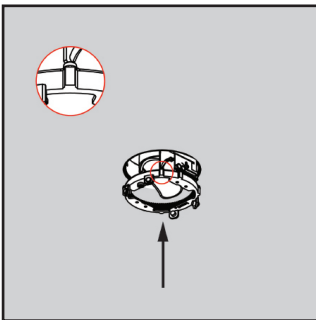

9. Align fixture with trimless mud in kit

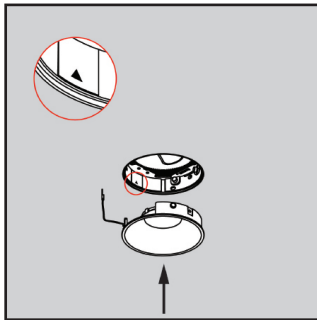

10. Attach safety wire to keyhole.
Align cover with indicator and install

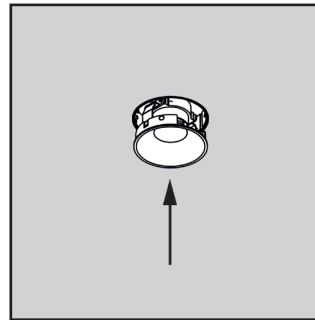

11. Install fixture

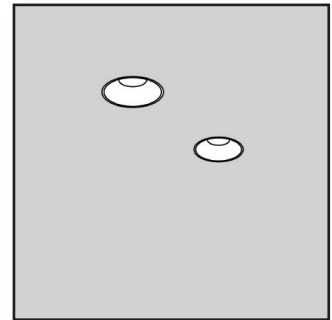

12. Finished Installation

Fixture Adjustment Instructions

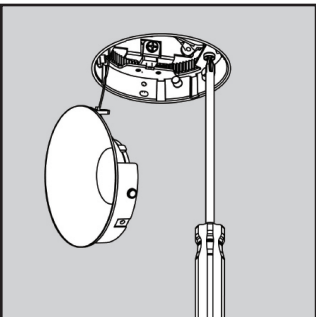

1. Adjust rotation

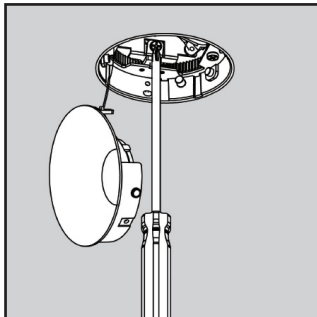

2. Adjust tilt

Installation Instructions for Plus 3.5" Conical Flangeless Accent with Tray

For Insulated and Non-Insulated Ceiling type installations



MAINS POWER TO BE SWITCHED OFF DURING INSTALLATION.

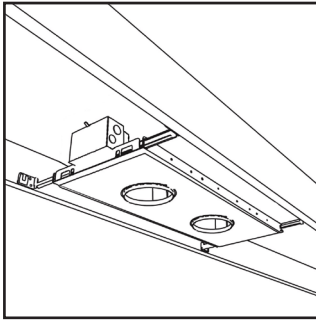

1. Fixing of housing

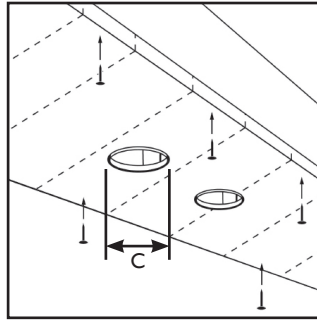

2. Plasterboard installation
Cutout (C): Ø4" (102mm)

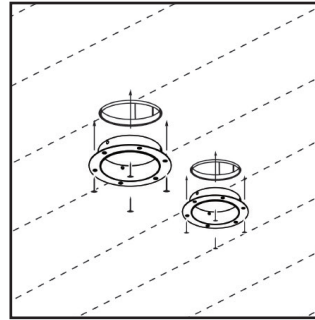

3. Trimless mud in kit installation

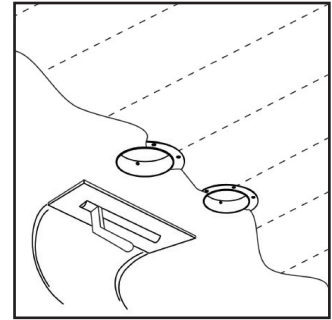

4. Mud in and allow to dry fully

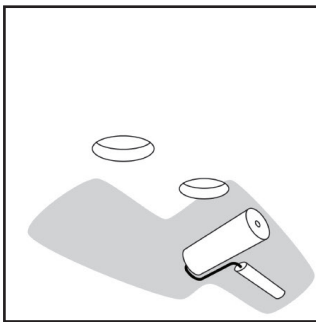

5. Paint and allow to dry fully

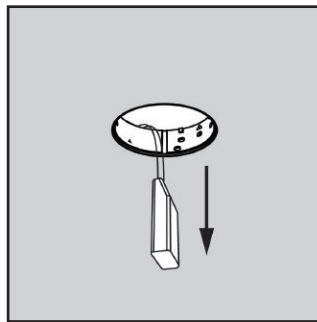

6. Dropdown of power supply

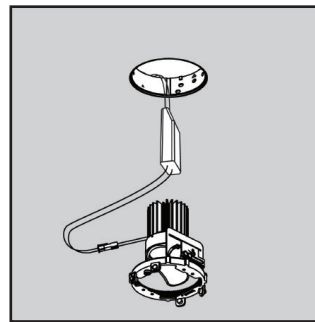

7. Fixture wiring connection

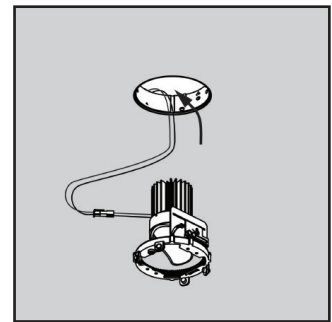

8. Power supply re-installation

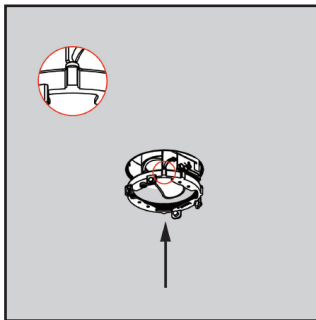

9. Align fixture with trimless mud in kit

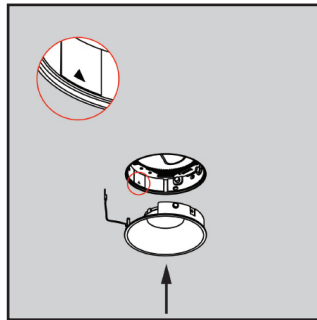

10. Attach safety wire to keyhole.
Align cover with indicator and install

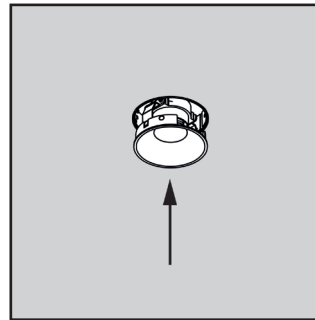

11. Install fixture

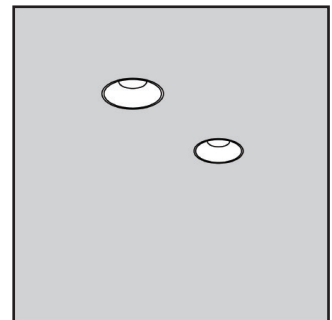

12. Finished Installation

Fixture Adjustment Instructions

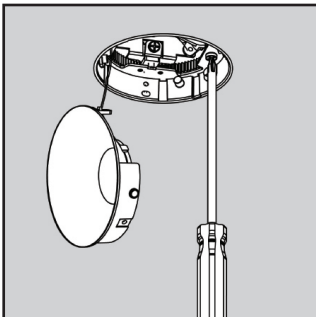

1. Adjust rotation

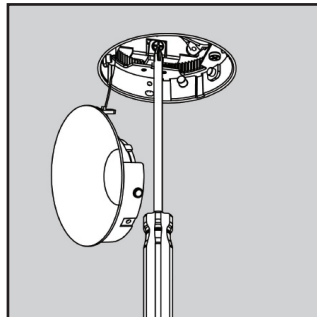

2. Adjust tilt