

## Installation Instructions for Plus 3.5" Pinhole Flangeless Fixed with Housing

For Insulated and Non-Insulated Ceiling type installations

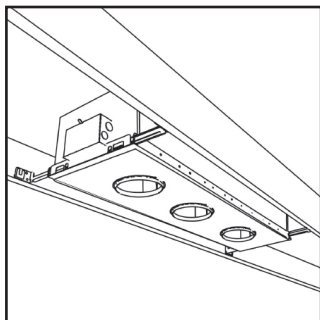

**MAINS POWER TO BE SWITCHED OFF DURING INSTALLATION.**



1. Fixing of housing

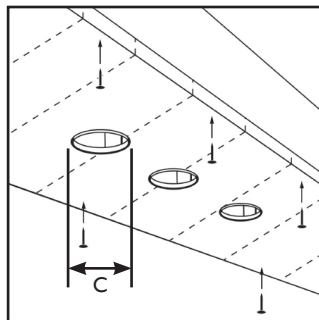

2. Plasterboard installation  
Cutout (C): Ø4" (102mm)

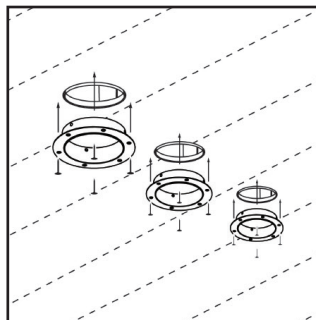

3. Trimless mud in kit installation

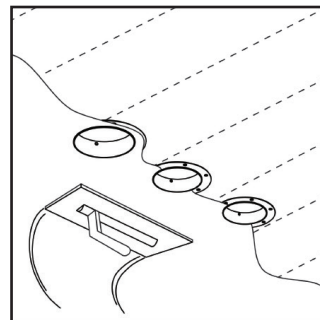

4. Mud in and allow to dry fully

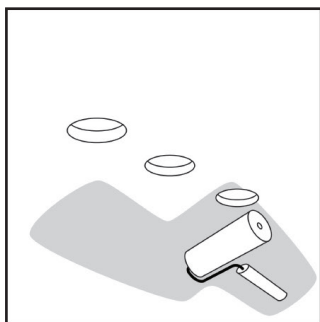

5. Paint and allow to dry fully

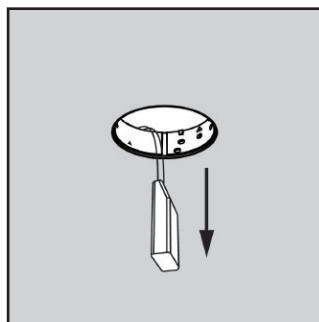

6. Dropdown of power supply

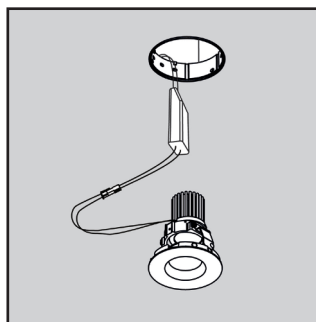

7. Fixture wiring connection

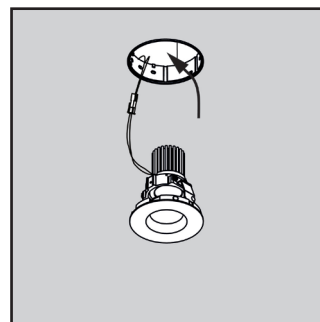

8. Power supply re-installation

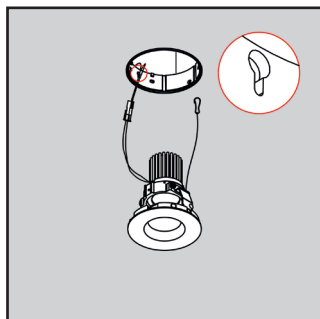

9. Attach safety wire to leyhole

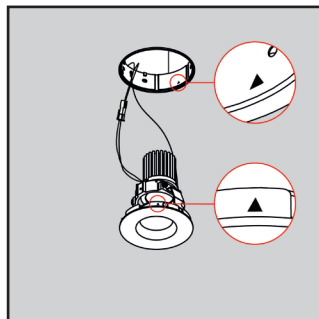

10. Align indicator on fixture with  
indicator on trim kit

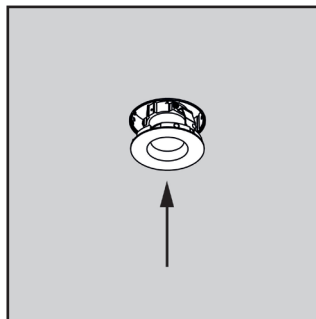

11. Install fixture

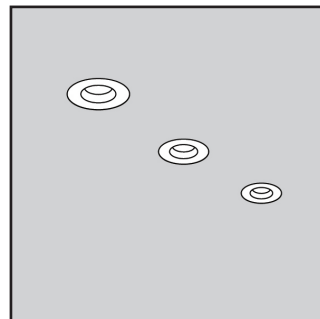

12. Finished Installation

## Installation Instructions for Plus 3.5" Pinhole Flangeless Fixed with Tray

For Insulated and Non-Insulated Ceiling type installations



**MAINS POWER TO BE SWITCHED OFF DURING INSTALLATION.**

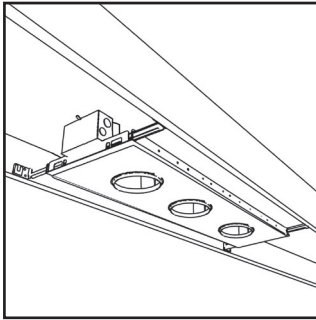

1. Fixing of tray

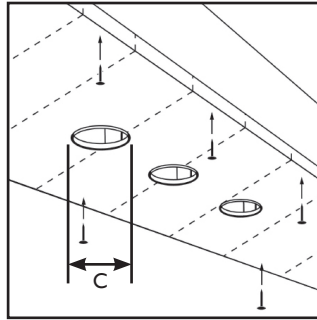

2. Plasterboard installation  
Cutout (C): Ø4" (102mm)

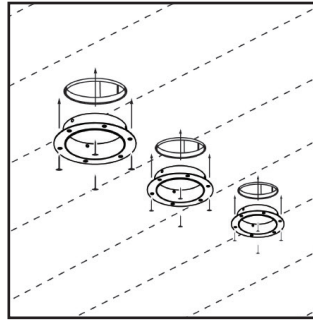

3. Trimless mud in kit installation

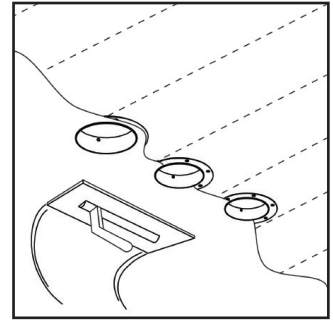

4. Mud in and allow to dry fully

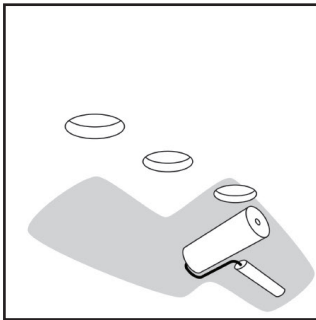

5. Paint and allow to dry fully

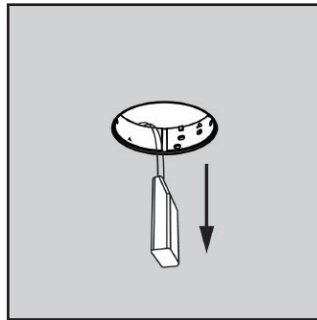

6. Dropdown of power supply

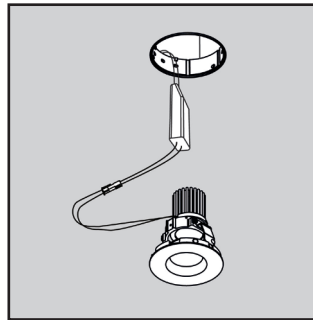

7. Fixture wiring connection

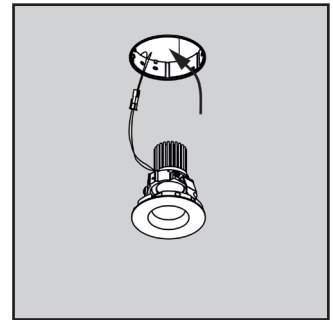

8. Power supply re-installation

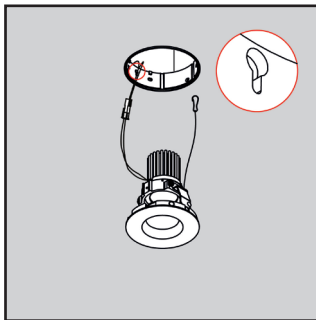

9. Attach safety wire to leyhole

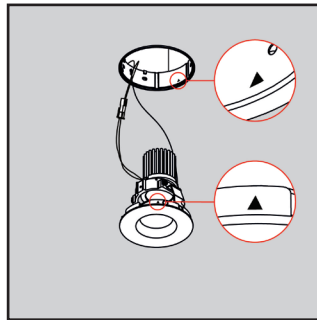

10. Align indicator on fixture with  
indicator on trim kit

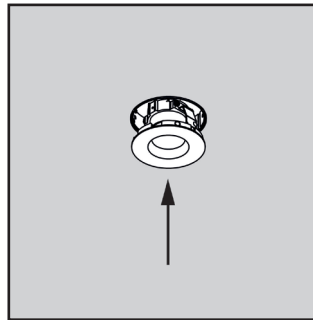

11. Install fixture

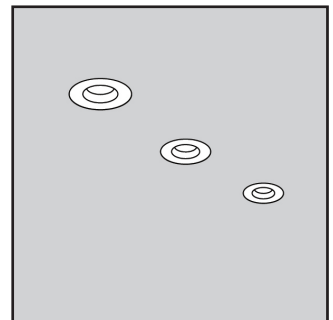

12. Finished Installation